



NOTICE



INC.

806 Metcalf St., Sedro-Woolley, WA 98284, (206) 855-2121 • FAX (206) 855-1858

JOHN ABENROTH
REGISTERED LAND SURVEYOR
NO. 17651

PROPERTY DESCRIPTIONS
FOR
PACIFIC NORTHWEST PROPERTIES
OF
TAX ASSESSMENT PARCELS IN
CROSSROADS SQUARE
SEDRO WOOLLEY, WASHINGTON

8 2/10 00

'92 MAR 10 10:02

RECORDED... FILED...
REQUEST OF...

February 12, 1992

9203100006

Those portions of Lot 2, Short Plat No. SW-0284, approved January 11, 1985, recorded January 14, 1985, in Book 6 of Short Plats, at Page 200, under Auditor's File No. 8501140002, as shown on unrecorded site plan of "Asbuilt drawing of CROSSROADS SQUARE" prepared by Skagit Surveyors Inc. and dated November 28, 1990, described as follows:

PARCEL 1

Beginning at the northeast corner of said Lot 2; thence S 89°48'49"W along the north line of said Lot 2, a distance of 679.67 feet to the northwest corner of said Lot 2; thence S 00°11'11"E along the west line of said Lot 2, a distance of 428.16 feet to an angle point in said west line; thence N 89°48'49"E along said west line, a distance of 143.66 feet to an angle point in said west line; thence N 00°11'11"W along the prolongation of a portion of said west line, a distance of 245.39 feet; thence East, a distance of 536.80 feet to the east line of said Lot 2; thence N 00°25'52"W along said east line, a distance of 184.52 feet to the point of beginning of this description.

Containing 160,020 square feet = 3.67 acres.

PARCEL 2

Commencing at the southwest corner of said Lot 2; thence N 00°11'11"W along the west line and the prolongation of the west line of said Lot 2, a distance of 920.99 feet; thence East, a distance of 55.00 feet to the point of beginning of this description; thence continuing East, a distance of 208.62 feet; thence South a distance of 80.00 feet; thence West, a distance of 208.36 feet to a point that is 55.00 feet east of said prolongation of a portion of said west line; thence N 00°11'11"W a distance of 80.00 feet to the point of beginning of this description.

Containing 16,679 square feet = 0.38 acres.

9203100006

BK 1055 PG 0377

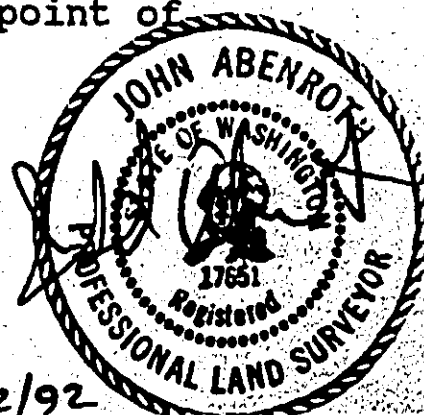

2/12/92

03 12 1992

05 13 0440

PARCEL 3

Commencing at the southwest corner of said Lot 2; thence N 00°11'11"W along the west line of said Lot 2, a distance of 645.99 feet; thence East, a distance of 55.00 feet to the point of beginning of this description; thence continuing East, a distance of 199.72 feet; thence North, a distance of 195.00 feet to the south line of Parcel 2 described above; thence West along the south line of said Parcel 2, a distance of 200.36 feet to the southwest corner of said Parcel 2; thence S 00°11'11"E, a distance of 195.00 feet to the point of beginning of this description.

Containing 39,007 square feet = 0.89 acres.

PARCEL 4

Commencing at the southwest corner of said Lot 2; thence N 00°11'11"W along the west line of said Lot 2, a distance of 645.99 feet; thence East, a distance of 156.72 feet to a point on the south line of Parcel 3 described above and point of beginning of this description; thence South, a distance of 52.00 feet; thence West, a distance of 10.00 feet; thence South, a distance of 16.00 feet; thence East, a distance of 10.00 feet; thence South, a distance of 32.00 feet; thence East, a distance of 98.00 feet; thence North, a distance of 12.50 feet; thence West, a distance of 18.00 feet; thence North, a distance of 87.50 feet to the south line of said Parcel 3; thence West along said south line, a distance of 80.00 feet to the point of beginning of this description.

Containing 8,385 square feet = 0.19 acres.

PARCEL 5

Commencing at the southwest corner of said Lot 2; thence N 00°11'11"W along the west line of said Lot 2, a distance of 545.99 feet; thence East, a distance of 55.00 feet to the point of beginning of this description; thence continuing East, a distance of 101.39 feet to the southwest corner of Parcel 4 described above; thence continuing East along the south line of said Parcel 4, a distance of 98.00 feet to the southeast corner of said Parcel 4; thence South, a distance of 226.67 feet; thence West, a distance of 198.66 feet to a point that is 55.00 feet east of the west line of said Lot 2; thence N 00°11'11"W, a distance of 226.67 feet to the point of beginning of this description.

Containing 45,113 square feet = 1.04 acres.

9203100006

BK 1055 PG 0378

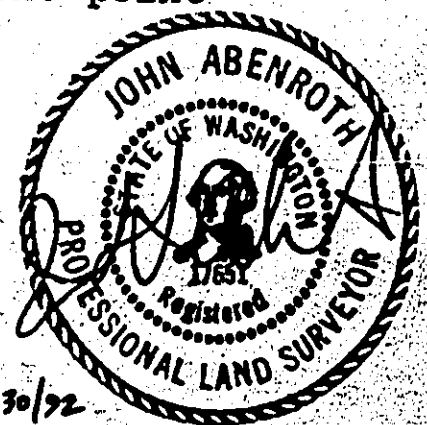

1/30/92

PARCEL 6

Commencing at the southwest corner of said Lot 2; thence N 60°19'28"E along the south line of said Lot 2, a distance of 98.94 feet to the point of beginning of this description; thence continuing N 60°19'28"E along the south line of said Lot 2, a distance of 214.94 feet; thence N 27°37'45"W, a distance of 22.79 feet to the point of curvature of a curve to the right having a radius of 47.70 feet; thence along said curve through a central angle of 27°40'13" and an arc length of 23.04 feet; thence N 00°02'28"E, a distance of 61.49 feet to the point of curvature of a curve to the left having a radius of 10.10 feet; thence along said curve through a central angle of 89°46'14" and an arc length of 15.82 feet; thence N 89°43'46"W, a distance of 201.01 feet to the point of curvature of a curve to the left having a radius of 9.50 feet; thence along said curve through a central angle of 83°34'21" and an arc length of 13.86 feet; thence S 06°41'53"W, a distance of 19.90 feet; thence S 00°04'11"E, a distance of 97.12 feet to the point of curvature of a curve to the left having a radius of 21.40 feet; thence along said curve through a central angle of 29°49'58" and an arc length of 11.14 feet; thence S 29°54'09"E, a distance of 98.50 feet to the point of beginning of this description.

Containing 38,780 square feet = 0.89 acres.

PARCEL 7

Lot 2 of said Short Plat No. SW-0284; EXCEPT Parcel 1, Parcel 2, Parcel 3, Parcel 4, Parcel 5, and Parcel 6, described above.

Containing 286,233 square feet = 6.57 acres.

Situated in Skagit County, Washington.

The above descriptions do not constitute divisions of land and have been prepared for the sole purpose of tax assessment. The parcels described are not legal lots and may not be separately conveyed in the absence of a properly approved subdivision.

9203100006

BK1055PG0379



PACIFIC NORTHWEST PROPERTIES LEGAL DESCRIPTIONS
FEBRUARY 12, 1992

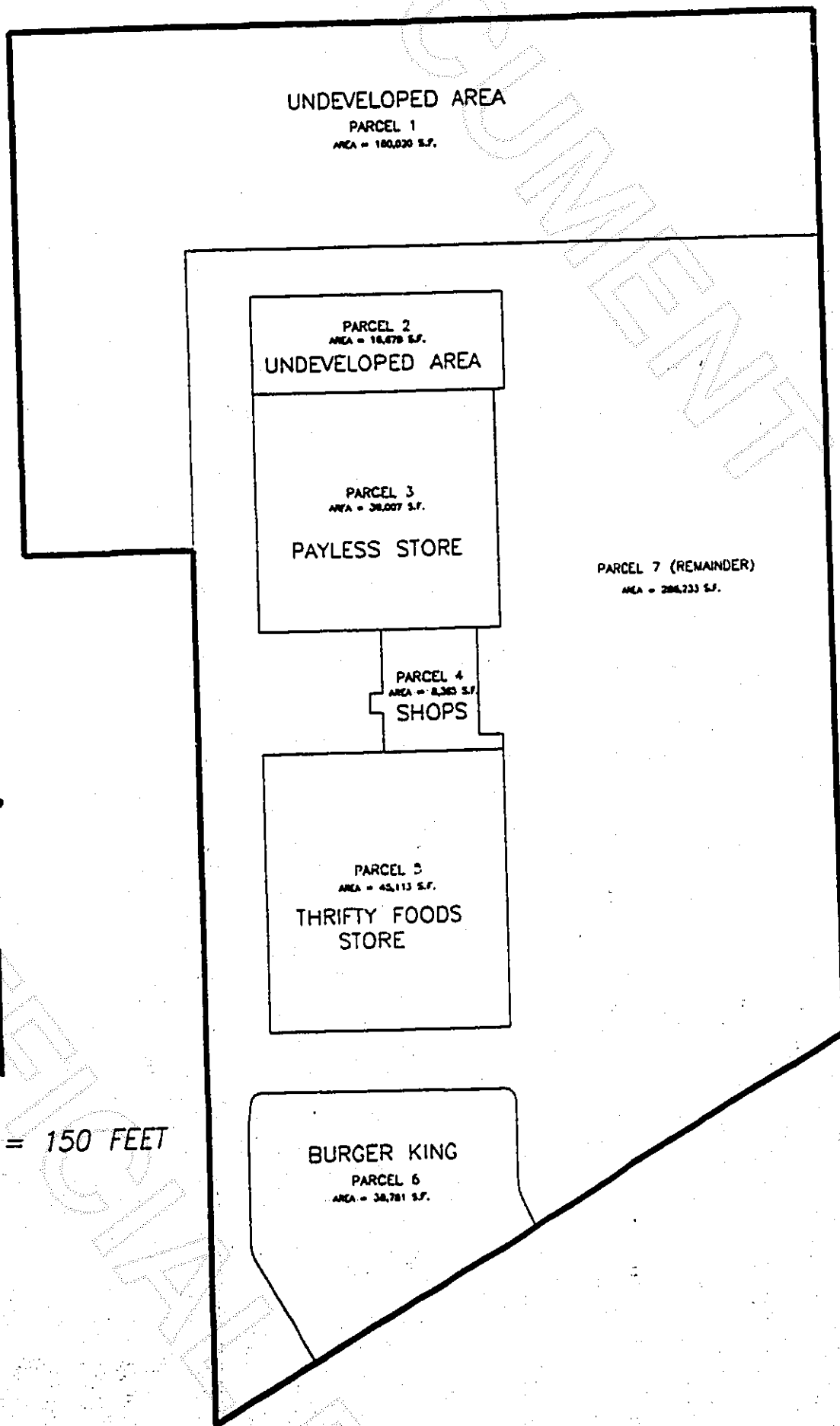

SCALE: 1 INCH = 150 FEET

9203100006

BK 1055 PG 0380

03 12 1992

05 13 0443