



200112040058  
Skagit County Auditor

12/4/2001 Page 1 of 3 12:04PM

Parcel No.: 3966-002-001-0001/P67954  
Legal Desc.: Ptn Lot 1, Tract 2, Peavey's Acreage

**QUIT CLAIM DEED**

**THE GRANTORS**, Andrew Young and Tietje Young, husband and wife, for and in consideration of NO MONETARY CONSIDERATION, boundary line adjustment purposes only, conveys and quit claims to Andrew Young and Tietje Young, husband and wife, **THE GRANTEES**, the following described real estate, situated in the County of Skagit, State of Washington, together with all after acquired title of the Grantor therein:

SKAGIT COUNTY WASHINGTON  
REAL ESTATE EXCISE TAX

# 44125  
DEC 04 2001

As attached hereto as Exhibit "A"

Amount Paid \$  
Skagit Co. Treasurer  
By *[Signature]* Deputy

The above described property will be combined or aggregated with contiguous property owned by the grantee and legally described on Exhibit "B" attached hereto. This boundary adjustment is not for the purposes of creating an additional building lot.

DATED this 3rd day of ~~November~~ <sup>December</sup>, 2001.

*[Signature]*  
Andrew Young

*[Signature]*  
Tietje Young

STATE OF WASHINGTON }  
County of Skagit } ss

I hereby certify that I know or have satisfactory evidence that Andrew Young and Tietje Young are the persons who personally appeared before me, and said persons acknowledged that they signed this instrument and acknowledged it to be their free and voluntary act for the uses and purposes mentioned in this instrument.

Dated this 3rd day of ~~November~~ <sup>December</sup>, 2001.

SHARON R. ANTHONY  
STATE OF WASHINGTON  
NOTARY --- PUBLIC  
My Commission Expires 9-6-2005

*[Signature]*  
Notary Public in and for the State  
of Washington, residing at  
Mount Vernon  
My appointment expires 9-6-2005



806 Metcalf St., Sedra-Woolley, WA 98284 Phone: (360) 855-2121 FAX: (360) 855-1658

Exhibit "A"  
BOUNDARY LINE ADJUSTMENT  
LEGAL DESCRIPTION  
FOR  
ANDY YOUNG  
OF

A PORTION OF LOT 1, TRACT No. 2, "PEAVEY'S ACREAGE  
TO BE AGGREGATED WITH  
LOT 12, TRACT No. 2, "PEAVEY'S ACREAGE"

October 23, 2001

Lot 1, Tract 2, PEAVEY'S ACREAGE, filed in Volume 3 of Plats at Page 37, records of Skagit County, Washington lying in the northeast quarter of the northwest quarter of Section 22, Township 35 North, Range 5 East, W.M.;

EXCEPT beginning at the southeast corner of the north 20 feet of said Lot 1; thence S01°07'59"W along the east line of said Lot 1, a distance of 231.66 feet; thence N89°23'19"W, a distance of 155.16 feet; thence N01°07'59"E, a distance of 17.97 feet; thence N89°23'19"W, a distance of 35.64 feet; thence N01°07'59"E, a distance of 102.49 feet to Point "A"; thence continuing N01°07'59"E, a distance of 111.21 feet to the south line of the north 20 feet of said Lot 1; thence S89°23'19"E along said south line, a distance of 190.80 feet to the point of beginning of this description;

AND EXCEPT county roads.

RESERVING an easement for well, well protection, pump house, water and utility lines over, under and through a 200 foot diameter circle the center of which is described as follows:

Beginning at the above described Point "A"; thence N88°52'01"W, a distance of 30.98 feet to the center of an existing well casing

Situate in Skagit County, Washington.

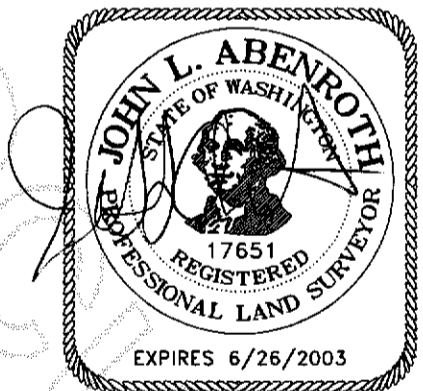

11/8/01



200112040058  
Skagit County Auditor

12/4/2001 Page 2 of 3 12:04PM

UNOFFICIAL DOCUMENT

Exhibit "B"

Lot 2, Tract 2, "PEAVEY'S ACREAGE, TRACTS NO. 1 & 2, SECTIONS 17, 20, 21, 22 & 28, TOWNSHIP 35 NORTH, RANGE 5 EAST, SKAGIT CO., WASH.", as per plat recorded in Volume 3 of Plats, page 37, records of Skagit County, Washington.

Situate in the County of Skagit, State of Washington.

**BOUNDARY ADJUSTMENT**

Reviewed and approved  
in accordance with S.C.  
Code Chapter 14.18



Gary Roeder  
SKAGIT CO. PLANNING & PERMIT CNTR

Date: 11/30/2001



200112040058  
Skagit County Auditor

12/4/2001 Page 3 of 3 12:04PM

UNOFFICIAL DOCUMENT