



200201300041

Skagit County Auditor

1/30/2002 Page 1 of 3 8:47AM

Parcel No.: 360408-1-001-0003/P49127  
 Legal Desc.: Ptn NE $\frac{1}{4}$ NE $\frac{1}{4}$ , 8-36-4 aka Ptn Tr.1 SP 95-031

## QUIT CLAIM DEED

m13120  
 LAND TITLE COMPANY OF SKAGIT COUNTY

**THE GRANTORS**, Daryl Kilwine and Meredith Kilwine, husband and wife, for and in consideration of NO MONETARY CONSIDERATION, boundary line adjustment purposes only, conveys and quit claims to Western Washington Corporation of Seventh-Day Adventists, a Washington non-profit corporation, **THE GRANTEE**, the following described real estate, situated in the County of Skagit, State of Washington, together with all after acquired title of the Grantor therein:

As attached hereto as Exhibit "A"

The above described property will be combined or aggregated with contiguous property owned by the grantee and legally described on Exhibit "B" attached hereto. This boundary adjustment is not for the purposes of creating an additional building lot.

DATED this 25 day of January, 2002.

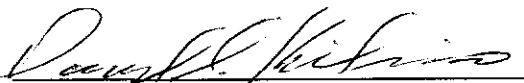
  
 Daryl Kilwine

  
 Meredith Kilwine

STATE OF WASHINGTON }  
 County of Skagit } ss

I hereby certify that I know or have satisfactory evidence that Daryl Kilwine and Meredith Kilwine are the persons who personally appeared before me, and said persons acknowledged that they signed this instrument and acknowledged it to be their free and voluntary act for the uses and purposes mentioned in this instrument.

Dated this 25<sup>th</sup> day of January, 2002.

SKAGIT COUNTY WASHINGTON  
 REAL ESTATE EXCISE TAX

# 374

JAN 30 2002

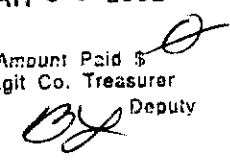
Amount Paid \$  
 Skagit Co. Treasurer  
 By  Deputy

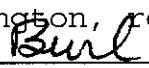

Notary Public in and for the State  
 of Washington, residing at

  
 My appointment expires 3-3-05



806 Metcalf St., Sedro-Woolley, WA 98284 Phone: (360) 855-2121 FAX: (360) 855-1658

BOUNDARY LINE ADJUSTMENT  
LEGAL DESCRIPTION  
FOR  
WESTERN WASHINGTON CORPORATION OF SEVENTH DAY ADVENTISTS  
OF  
A PORTION OF LOT 1 SP No.95-031  
TO BE AGGREGATED WITH  
THE SOUTHEAST QUARTER OF THE SOUTHEAST QUARTER OF SECTION 5,  
TOWNSHIP 36 NORTH, RANGE 4 EAST, W.M.

December 17, 2001

That portion of Lot 1, Short Plat No. 95-031, approved August 10, 1998, filed in Volume 13 of Short Plats at Pages 153 and 154, records of Skagit County, Washington, described as follows:

Commencing at the northeast corner of Lot 1, being the northeast corner of Section 8, Township 36 North, Range 4 East, W.M.; thence N87°30'06"W along the north line of said Section 8, a distance of 170.94 feet to the point of beginning of this description; thence S59°01'50"W, a distance of 39.08 feet to the Butler Creek Road; thence northwesterly along the Butler Creek Road, a distance of 30.06 feet to the north line of said Section 8; thence S87°30'06"E along said north line, a distance of 53.47 feet, more or less, to the point of beginning of this description.

Situate in Skagit County, Washington.

Containing 559 square feet, more or less.

**BOUNDARY ADJUSTMENT**

Reviewed and approved  
in accordance with S.C.  
Code Chapter 14.18

*John L. Abenroth*  
SKAGIT CO. PLANNING & PERMIT CNTR

Date: 1/17/2002



200201300041  
Skagit County Auditor

1/30/2002 Page 2 of 3 8:47AM

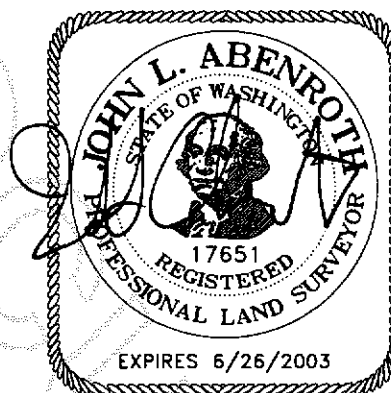

1/8/2002

**Exhibit "B"**

That portion of the Southeast  $\frac{1}{4}$  of the Southeast  $\frac{1}{4}$  of Section 5, Township 36 North, Range 4 East, W.M., lying Easterly of the Easterly line of the revised 60 foot wide Alger-Cain Lake Road as said road was conveyed to Skagit County for road purposes by deed dated May 18, 1953 and recorded June 25, 1953 under Auditor's File No. 489882, records of Skagit County, Washington.

EXCEPT that portion of the South 30 feet of said Southeast  $\frac{1}{4}$  of the Southeast  $\frac{1}{4}$  lying between the boundaries of the Old Alger-Cain Lake Road and the C.C.C. Road, as said C.C.C. Road existed on July 9, 1945, and as reserved by deed recorded September 12, 1945 under Auditor's File No. 383122, records of Skagit County, Washington.

ALSO, EXCEPT that portion thereof lying within the boundaries of the as built and existing county road known as the C.C.C. Road and also being referred to as the Alger C.C. Road and also being referred to as the Old Bloedel-Donovan Construction Railway right-of-way.

ALSO, EXCEPT that portion thereof, if any, lying within the boundaries of the as built and existing county road commonly known as the Butler Creek Road.

Situate in the County of Skagit, State of Washington



200201300041

Skagit County Auditor

1/30/2002 Page 3 of 3 8:47AM