

RETURN ADDRESS



200202140024
Skagit County Auditor

2/14/2002 Page 1 of 4 10:00AM



MANUFACTURED HOME APPLICATION

PLEASE CHECK ONE

- TITLE ELIMINATION
- TRANSFER IN LOCATION
- REMOVAL FROM REAL PROPERTY

Anyone who knowingly makes a false statement of a material fact is guilty of a felony, and upon conviction may be punished by a fine, imprisonment, or both. (RCW 46.12.210)

1 MANUFACTURED HOME

TPO / PLATE NUMBER	YEAR	MAKE	LENGTH/WIDTH(FEET)	VEHICLE IDENTIFICATION NUMBER (VIN)
	1982	ELCAR	48 X 24	MG3596 A/B

2 LAND

LEGAL DESCRIPTION ON PAGE

MANUFACTURED HOME WILL BE AFFIXED REMOVED

REAL PROPERTY TAX PARCEL NUMBER: 3867-000-081-0701, 4030-000-010-0103

LOT	BLOCK	PLAT NAME	SECTION/TOWNSHIP/RANGE
		see schedule A-1 attached	Tb 81 Burlington Ae. pg 3

3 GRANTOR(S) REGISTERED/LEGAL OWNER(S)

ADDITIONAL NAMES ON PAGE

COUNTY NUMBER	NUMBER OF REGISTERED OWNERS	NUMBER OF LEGAL OWNERS
29	One	One

NAME OF REGISTERED OWNER: Malinda L. Daniel

NAME OF ADDITIONAL REGISTERED OWNER:

DOL. CUST. Acct # DANIE MDS 75 QM

ADDRESS: CITY: STATE: ZIP CODE:

NAME OF LEGAL OWNER: Malinda L. Daniel

NAME OF ADDITIONAL LEGAL OWNER:

ADDRESS: CITY: STATE: ZIP CODE:

ADDRESS: CITY: STATE: ZIP CODE:

ADDRESS: CITY: STATE: ZIP CODE:

GRANTEE NAME:

I DO SOLEMNLY ATTEST UNDER PENALTY OF PERJURY THAT I / WE AM/ARE THE REGISTERED OWNER(S) OF THIS VEHICLE AND THIS INFORMATION IS ACCURATE:

Signature of Registered Owner and Title, IF APPLICABLE: *Malinda L. Daniel*

Signature of Additional Registered Owner and Title, IF APPLICABLE:

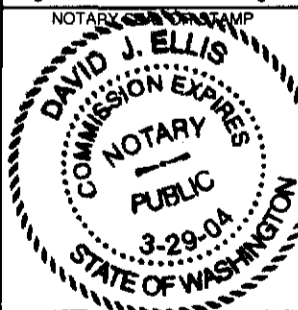

NOTARIZATION/CERTIFICATION FOR REGISTERED OWNER(S) SIGNATURE

State of Washington County of SKAGIT

Signed or attested before me on 2-13-02

by Malinda L. Daniel Signature David J. Ellis

PRINT NAME OF REGISTERED OWNER NOTARY OR AGENT

by David J. Ellis

PRINT NAME OF NOTARY

County/Office No. OR Dealer No. OR Notary Expiration Date 2-29-04

4 TITLE COMPANY CERTIFICATION

I certify that the legal description of the land and ownership is true and correct per the real property records.

NAME (TYPED OR PRINTED): Shelley Langness TITLE COMPANY / PHONE NUMBER: First American Title (800) 869-7045

SIGNATURE / POSITION: *(See attached)* Title Officer DATE: 2-13-02

Finalize this application with a Licensing Agent within 10 calendar days of the date Title Company Representative signs.

5 BUILDING PERMIT OFFICE CERTIFICATION

I certify that:

- the manufactured home has been affixed to the real property as described.
- a building permit has been issued for this purpose and the attachment will be inspected upon completion.

NAME (TYPED OR PRINTED)	BLDG PERMIT OFFICE/PHONE #	BLDG PERMIT #

SIGNATURE / POSITION	DATE

6 SIGNATURE OF LEGAL OWNER

SIGNATURE OF LEGAL OWNER INDICATES CONSENT FOR ELIMINATION OF TITLE / REMOVAL FROM REAL PROPERTY.

Signature of Legal Owner and Title, IF APPLICABLE *Malinda L. Daniel*

Signature of Additional Legal Owner and Title, IF APPLICABLE _____

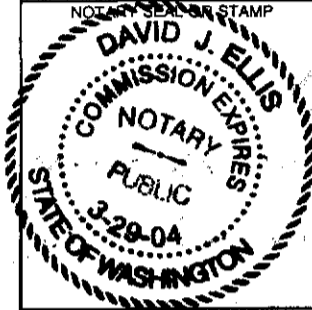

NOTARIZATION/CERTIFICATION FOR LEGAL OWNER(S) SIGNATURE

State of Washington County of *SKAGIT* Signed or attested before me on *2-13-02*

by *Malinda L. Daniel* Signature *David J. Ellis*
PRINT NAME OF LEGAL OWNER NOTARY OR AGENT

by _____
PRINT NAME OF LEGAL OWNER PRINTED NAME OF NOTARY

Title _____ AND: County/Office No. OR Dealer No. OR Notary Expiration Date *3-29-04*

7 LAND DESCRIPTION (A legal description of the land can be obtained from the local County Assessor's Office)

8 DEALER'S REPORT OF SALE

I CERTIFY THAT THIS INFORMATION IS CORRECT. THE VEHICLE IS CLEAR OF ENCUMBRANCES EXCEPT AS SHOWN. ANY REQUIRED SALES TAX HAS BEEN COLLECTED.

DEALER NAME (TYPED OR PRINTED)		WA DEALER NUMBER	DATE OF SALE
PURCHASE PRICE	TAX JURISDICTION/TAX RATE	DEALER'S AUTHORIZED SIGNATURE	

USE TAX EXEMPT Sale to a Certified Tribal member on the reservation (attach notarized statement of delivery).

9 COUNTY AUDITOR/AGENT LICENSING OFFICE APPROVAL: (Not for use by Subagents)

I certify that the above application appears to have been completed correctly, and the applicant has sufficient documentation to proceed with the recording of this form.

NAME (TYPED OR PRINTED) <i>PEGGY A. RIEDEL GRAHAM</i>	COUNTY OFFICE/VFS OPERATOR NUMBER <i>29-01-04</i>
SIGNATURE <i>Peggy A. Riedel Graham</i>	DATE <i>2/13/02</i>

10 TITLE FEES

FILING FEE	APPLICATION	MOBILE HOME FEE	ELIMINATION FEE	USE TAX	SUBAGENT FEES
					TOTAL FEES & TAX

IMPORTANT: Once the application has been approved by the County Auditor / Vehicle Licensing Office, take your application form to the County Recording Office. Retain proof of the recording fees paid. If the Recording Office retains your original application form, obtain a certified copy of the recorded form.

APPLICANTS: Once recorded, you must return to a Vehicle Licensing office to file the Manufactured Home Application, paying all required fees. Vehicle licensing subagents charge a service fee.

For full instructions on completing this form for Title Elimination, Removal from Real Property or Transfer in Location, see form TD-420-730, Manufactured Home Application Instructions.

The Department of Licenses
If you need special accom





First American Title Company of Skagit County

P.O. Box 1667, 1301-B Riverside Dr., Mount Vernon, WA 98273

(360) 424-0115, 1-800-869-7045, FAX (360) 424-5885

"We hereby certify that the true and correct legal description of the premises highlighted on the attached map is as follows:

PARCEL "A":

Those portions of Tract 81, "PLAT OF THE BURLINGTON ACREAGE PROPERTY", as per plat recorded in Volume 1 of Plats, page 49, records of Skagit County, Washington, described as follows:

1. Beginning at a point 503.81 feet East of the Southwest corner of said Tract 81;
thence North along the East boundary of "THORNTON ADDITION, BURLINGTON, WASH.", as per plat recorded in Volume 7 of Plats, page 42, records of Skagit County, a distance of 111.55 feet;
thence Easterly on a bearing South 89°28' East a distance of 100 feet;
thence South parallel to the East boundary of said Thornton Addition, a distance of 111.55 feet;
thence Westerly 100 feet to the point of beginning,

EXCEPT that portion, if any, lying East of the West boundary of the East 31.1 feet of the West ¼ of said Tract 81.

2. Beginning at a point 503.81 feet East of the Southwest corner of said Tract 81;
thence North along the East boundary of "THORNTON ADDITION, BURLINGTON, WASH.", as per plat recorded in Volume 7 of Plats, page 42, records of Skagit County, Washington, a distance of 111.55 feet to the true point of beginning;
thence continuing 50 feet in a straight line along the East end of Cul De Sac Drive;
thence Easterly on a bearing South 89°28' East a distance of 100 feet;
thence South parallel to the East boundary of Thornton Addition a distance of 50 feet;
thence Westerly 100 feet to the true point of beginning,

EXCEPT that portion, if any, lying East of the West boundary of the East 31.1 feet of the West ¼ of said Tract 81.

Situate in the County of Skagit, State of Washington.

PARCEL "B":

The East 3.81 feet of Lot 10, "THORNTON ADDITION, BURLINGTON, WASH.", as per plat recorded in Volume 7 of Plats, page 42, records of Skagit County, Washington, as measured along the North and South lines thereof.

Situate in the County of Skagit, State of Washington.

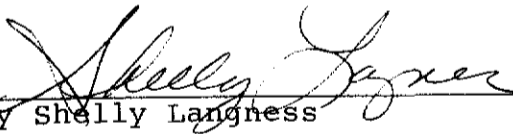

By Shelly Langness

Title Officer

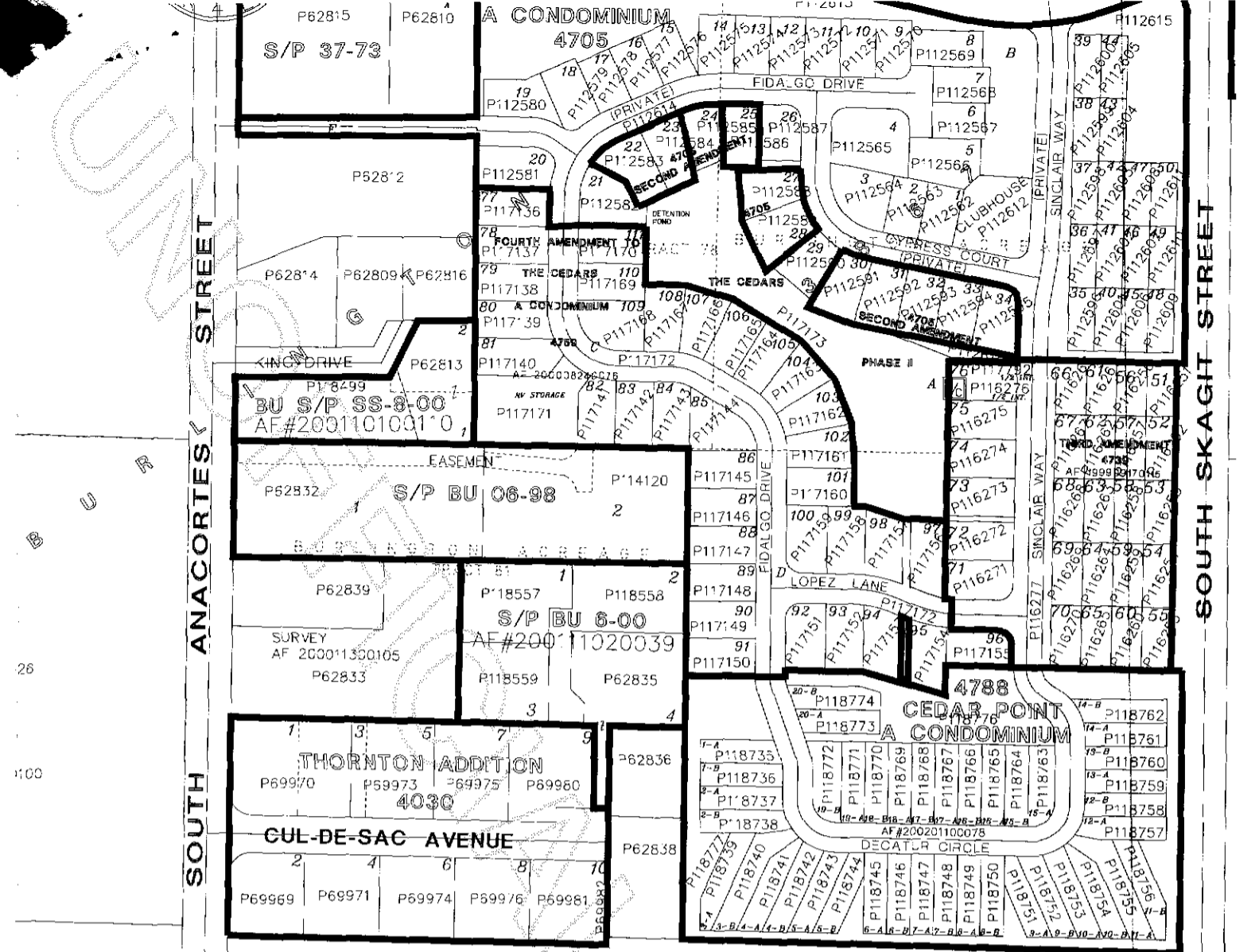

200202140024
Skagit County Auditor
2/14/2002 Page 3 of 4 10:00AM

Agents For
First American Title Insurance Company



45

0003090048
12848

LOT #

SURVEY
AF 9609110086
V18 P169

P131'68

P23535

P23540

P23533

P95682

P62853



200202140024
Skagit County Auditor
2/14/2002 Page 4 of 4 10:00AM