

Return to:

Patrick Davis



200408250063  
Skagit County Auditor

8/25/2004 Page 1 of 2 10:44AM

PROTECTED CRITICAL AREA SITE PLAN

Page 1 of 2

Grantor/Owner: Merle H. DAVIS

Grantee: PUBLIC

Site Address: 18027 West Big Lake Blvd.

Property ID #: P 62001/62004 Assessors Tax Account #: \_\_\_\_\_

Legal Description: Sec. 1 Twp. 33 Rng. 4 / Plat Name \_\_\_\_\_ Lot \_\_\_\_\_

Permit/Activity #: PL04-0400

The PROTECTED CRITICAL AREA (PCA) is to be left undisturbed in its natural state. "With the exception of activities identified as Allowed without Standard review under SCC 14.24.100, any land-use activity that can impair the functions and values of critical areas or their buffers through a development activity or by disturbance of the soil or water, and/or by removal of, or damage to, existing vegetation shall require critical areas review and written authorization pursuant to SCC 14.24." SCC 14.24.060 No clearing, grading, filling, logging or removal of woody material, building, construction or road construction of any kind, planting of non-native vegetation or grazing of livestock is allowed within the PCA areas except as specifically permitted by Skagit County on a case-by-case basis consistent with SCC 14.24.

Representations on this site plan may be approximations only and should not be used for purposes other than for determining general locations of critical areas. Development activities beyond the scope of this plan may require additional studies and approvals.

The above references to "Grantor" and "Grantee" shall not be construed as a transfer of property ownership and are used solely for filing with the County Auditor.

Owner: Merle H. Davis Date: 7-30-04

On this day personally appeared before me MERLE H. DAVIS known to be the individual described herein and acknowledged to me that HE signed the same as HIS free and voluntary act and deed for the uses and purposes therein mentioned.

Olen Bosma  
residing at SEATTLE Notary Public in and for the State of Washington, Date: 7-30-04

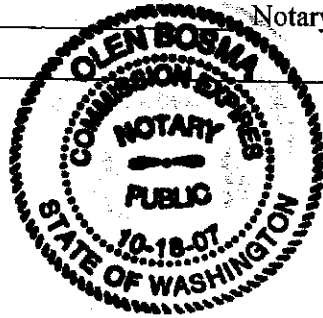

CRITICAL AREA SITE PLAN

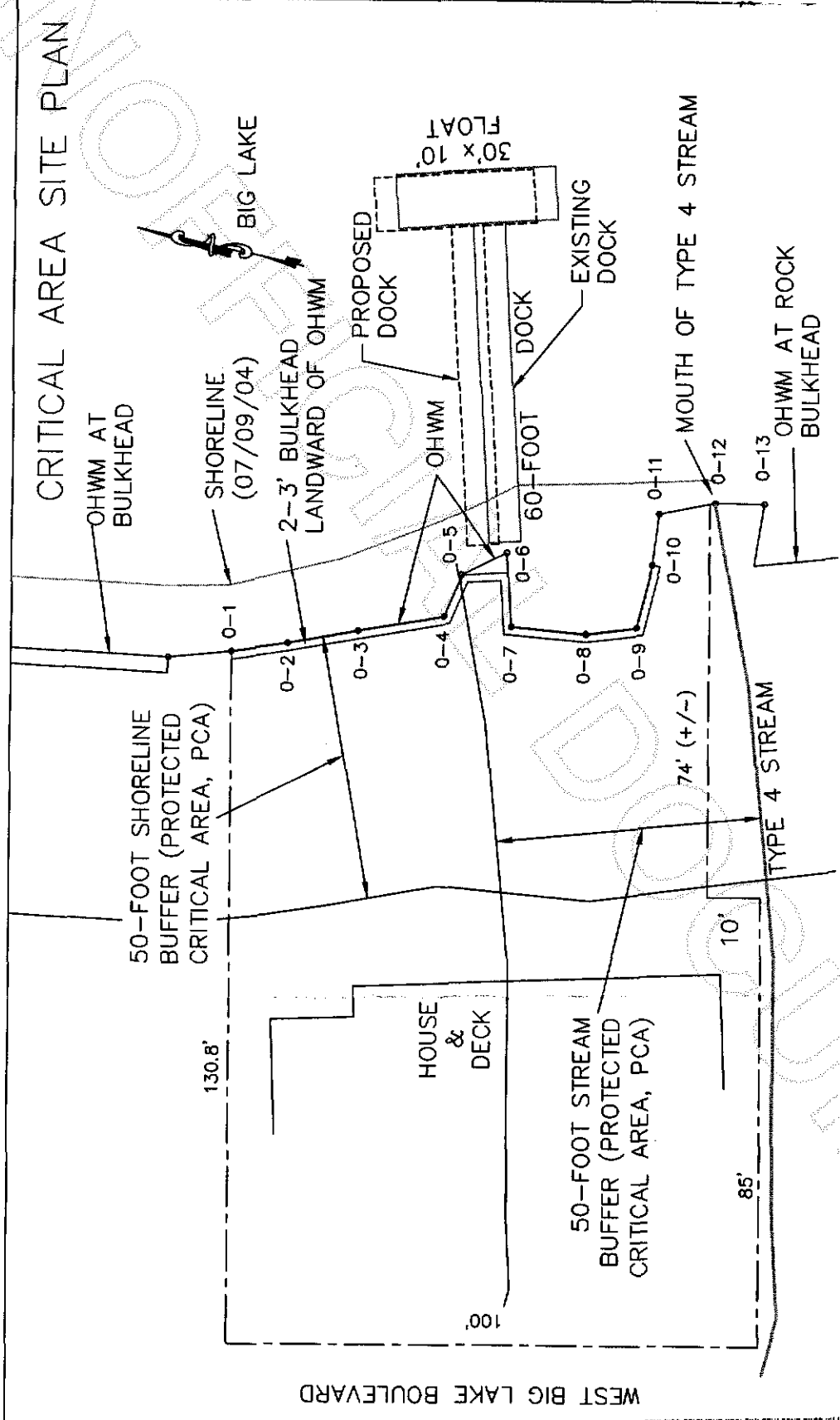

This drawing was created with a compass and tape measure and is approximate.  
**NOT A SURVEY**

Owner: Merle H. Davis  
 Address: 18027 W. Big Lk. Blvd.  
 Parcel: P62001 & P62004  
 Permit: PL04-0400  
 Preparer: Edison Engineering  
 Date: July, 2004

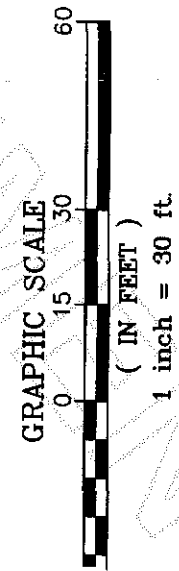

WEST BIG LAKE BOULEVARD

200408250063  
 Skagit County Auditor