

Return Name & Address:

Sanfi Acres LLC
103 N. Township Street
Sedro-Woolley, WA 98284



200605030133
Skagit County Auditor
5/3/2006 Page 1 of 2 2:52PM

SKAGIT COUNTY PLANNING & DEVELOPMENT SERVICES

LOT OF RECORD CERTIFICATION

File Number: PL 06 - 0224

Applicant Name: Sanfi Acres LLC

Property Owner Name: Sanfi Acres LLC

Having reviewed the information provided by the applicant, the Department hereby finds that the parcel(s) bearing Skagit County Parcel Number(s):

P#(s): 121718

Lot Size: 20 acres Description: S1/2 SW1/4 SE1/4 33-33-5

1. CONVEYANCE

- IS**, a Lot of Record as defined in Skagit County Code (SCC) 14.04.020 or owned by an innocent purchaser who has met the requirements described in SCC 14.18.000(9) and RCW 58.17.210 and therefore IS eligible for conveyance. (per AF# 9011080054)
- IS NOT**, a Lot of Record as defined in SCC 14.04.020 or owned by an innocent purchaser who has met the requirements described in SCC 14.18.000(9) and RCW 58.17.210 and therefore IS NOT eligible for conveyance or development.

2. DEVELOPMENT

- IS**, the minimum lot size required for the _____ zoning district in which the lot is located and therefore IS eligible to be considered for development permits.
- IS NOT**, the minimum lot size required for the _____ zoning district in which the lot is located, but does meet an exemption listed in SCC 14.16.850(4)(c) _____ and therefore IS eligible to be considered for development permits.
- IS NOT**, the minimum lot size required for the IF-NRL zoning district in which the lot is located, does not meet an exemption listed in SCC 14.16.850(4)(c) and therefore IS NOT eligible to be considered for certain development permits.

Authorized Signature: [Signature] Date: 4/25/2006

See attached map for Lot of Record boundaries.

SKAGIT COUNTY

6	5	4	3	2	1
7	8	9	10	11	12
13	14	15	16	17	18
19	20	21	22	23	24
25	26	27	28	29	30
31	32	33	34	35	36

T 33 N R 05 E

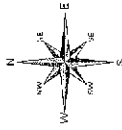

THIS MAP IS NOT A SUBSTITUTE FOR FIELD SURVEY.
 THE USER SHALL BE RESPONSIBLE FOR OBTAINING ALL NECESSARY PERMITS AND RIGHTS OF WAY.
 THIS MAP IS NOT TO BE USED FOR CONVEYANCE OF INTERESTS IN REAL ESTATE.
 THE USER SHALL BE RESPONSIBLE FOR OBTAINING ALL NECESSARY PERMITS AND RIGHTS OF WAY.
 THIS MAP IS NOT TO BE USED FOR CONVEYANCE OF INTERESTS IN REAL ESTATE.

DATE	INIT
DRAWN BY	11/20/06
REVISED	11/20/06
PLOTTED	11/20/06
MADE AVAILABLE BY	11/20/06
CHECKED BY	11/20/06

Section 33

T 33 N R 05 E

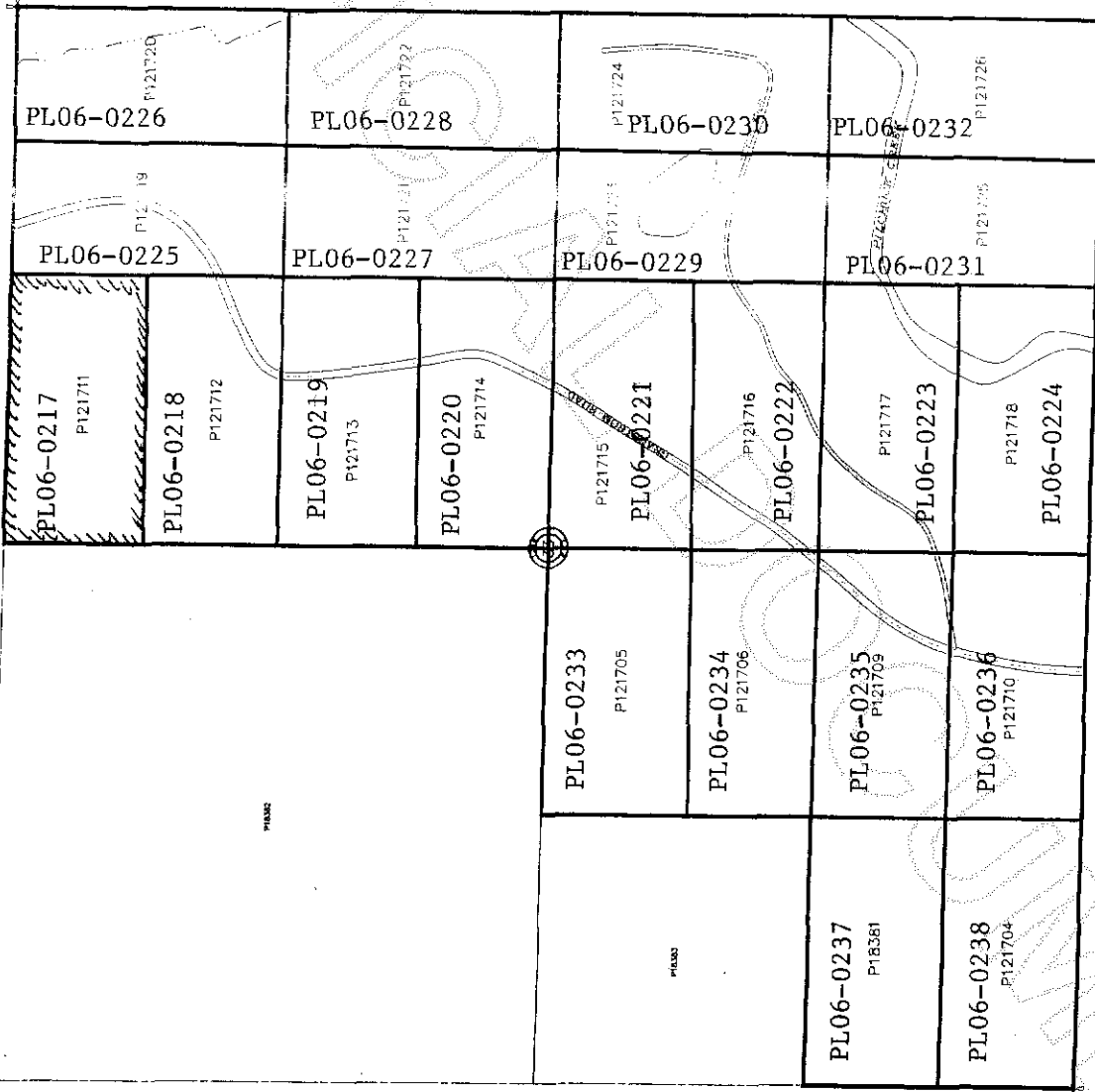

200605030133
 Skagit County Auditor