

Return to:

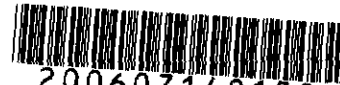

200607140159
Skagit County Auditor

7/14/2006 Page 1 of 2 3:44PM

PROTECTED CRITICAL AREA SITE PLAN

Page 1 of 2

Grantor/Owner:

Tom Jeffcott

Grantee: PUBLIC

Site Address:

5146 W. Shore Rd Anacortes WA

Property ID #: P 68048

Assessors Tax Account #: 3967 000 020 0001

Legal Description: Sec. 35 Twp. 36N Rng. 1E / Plat Name BRANCH BRANCH Lot 20

Permit/Activity #: BP06-0652 and BP06-0653 + P205-0268

The PROTECTED CRITICAL AREA (PCA) is to be left undisturbed in its natural state. "With the exception of activities identified as Allowed without Standard review under SCC 14.24.100, any land-use activity that can impair the functions and values of critical areas or their buffers through a development activity or by disturbance of the soil or water, and/or by removal of, or damage to, existing vegetation shall require critical areas review and written authorization pursuant to SCC 14.24." SCC 14.24.060 No clearing, grading, filling, logging or removal of woody material, building, construction or road construction of any kind, planting of non-native vegetation or grazing of livestock is allowed within the PCA areas except as specifically permitted by Skagit County on a case-by-case basis consistent with SCC 14.24.

Representations on this site plan may be approximations only and should not be used for purposes other than for determining general locations of critical areas. Development activities beyond the scope of this plan may require additional studies and approvals.

The above references to "Grantor" and "Grantee" shall not be construed as a transfer of property ownership and are used solely for filing with the County Auditor.

Owner:

Tom Jeffcott

Date:

7-10-06

On this day personally appeared before me Tom Jeffcott known to be the individual described herein and acknowledged to me that he signed the same as his free and voluntary act and deed for the uses and purposes therein mentioned.

residing at

Curtiss, R. Nelson
Mercer Island, WA

Notary Public in and for the State of Washington,

Date:

07-19-09

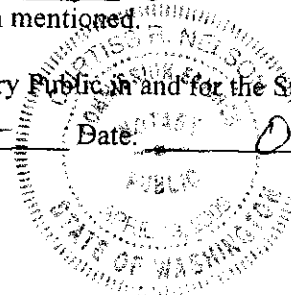

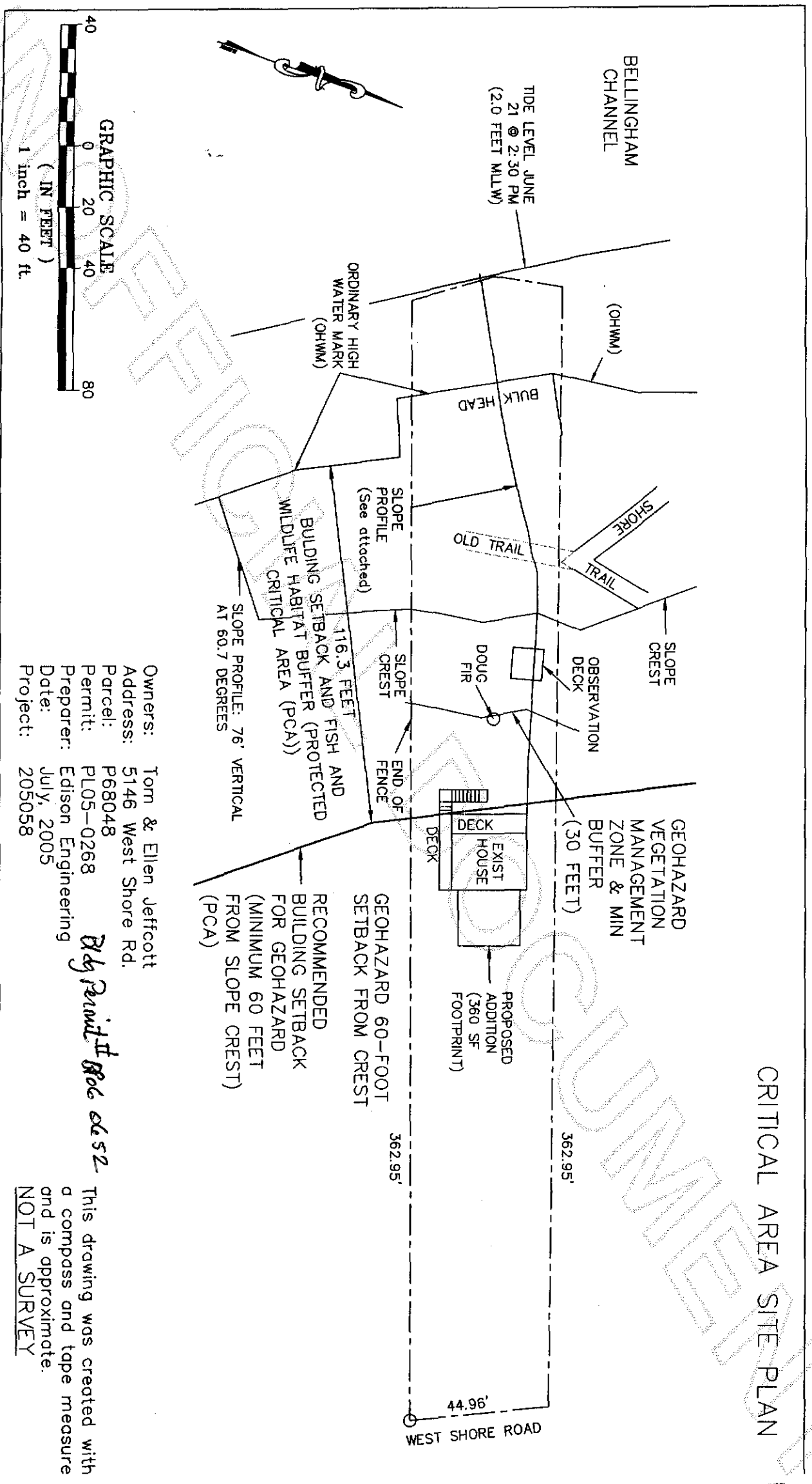

This drawing was created with a compass and tape measure and is approximate.
NOT A SURVEY

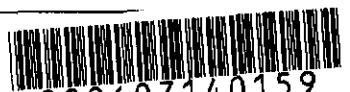

200607140159
 Skagit County Auditor