

AUDITOR'S CERTIFICATE
Filed for Record at the request of AZIMUTH NORTHWEST, INC.



200609150173
Skagit County Auditor
9/15/2006 Page 1 of 1 1 3:40PM

N. Brummett
SKAGIT COUNTY AUDITOR
DEPUTY

LEGAL DESCRIPTION (Onslow)

LOTS 5 AND 6, BLOCK 2, "MADRONA VIEW ADDITION TO SIMILK BEACH," AS PER PLAT RECORDED IN VOLUME 5 OF PLATS, PAGE 6, RECORDS OF SKAGIT COUNTY, WASHINGTON.

LEGAL DESCRIPTION (Church)

LOTS 7, 8, 9, AND 10, BLOCK 2, "MADRONA VIEW ADDITION TO SIMILK BEACH," AS PER PLAT RECORDED IN VOLUME 5 OF PLATS, PAGE 6, RECORDS OF SKAGIT COUNTY, WASHINGTON.

NOTES:

- 1. ● DENOTES REBAR AND CAP IMPRINTED "AZIMUTH N.W. 21591" SET THIS SURVEY.
- DENOTES IRON PIPE FOUND.
- x—x—x— DENOTES EXISTING FENCE LINE.
- 2. BASIS OF BEARING: MONUMENTED CENTERLINE OF SLICE ROAD AS SHOWN HEREIN AND ON PLAT OF MADRONA VIEW ADDITION TO SIMILK BEACH.
- 3. LEGAL DESCRIPTION OF LOTS 5 & 6 FROM STATUTORY WARRANTY DEED, RECORDED JULY 7, 2005 UNDER SKAGIT COUNTY AUDITOR'S FILE NO. 200507070060. SAID DEED SUBJECT TO EXCEPTIONS RECORDED AS PAGE 2 UNDER THE SAME RECORDING NUMBER AND DATE. SAID CONVEYANCE OCCURRED PRIOR TO BOUNDARY LINE ADJUSTMENT SHOWN HEREIN.
- 4. THIS SURVEY PERFORMED BY FIELD TRAVERSE USING A 3 SECOND ELECTRONIC DISTANCE MEASURING THEODOLITE.
- 5. THIS SURVEY DEPICTS EXISTING OCCUPATIONAL INDICATORS IN ACCORDANCE WITH WAC 532.130. THESE OCCUPATIONAL INDICATORS MAY INDICATE A POTENTIAL FOR CLAIMS OF UNWRITTEN TITLE. LEGAL OWNERSHIP BASED UPON UNWRITTEN TITLE CLAIMS HAVE NOT BEEN RESOLVED BY THIS SURVEY.

SURVEYOR'S CERTIFICATE

This map correctly represents a survey made by me or under my direction in conformance with the requirements of the SURVEY RECORDING ACT of the request of **DENNY ONSLOW** IN **JUNE** 2006.

Stuart B. VanBuren, Jr., P.L.S.
Certificate No. 21591

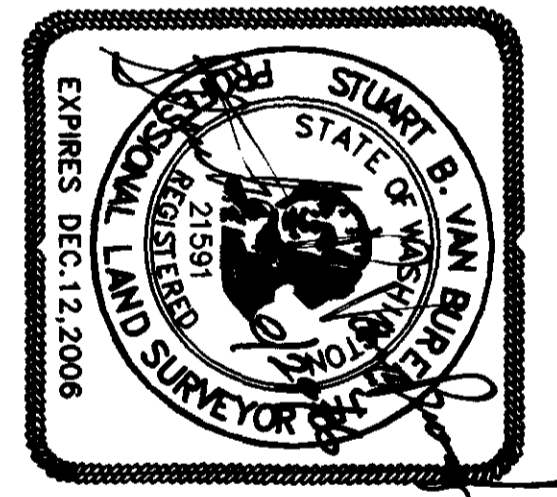

AZIMUTH NORTHWEST, INC.
17963 WOOD ROAD
BOW, WA, 98232
[360] 724-7326

| | |
|---|------------------|
| SURVEY IN THE SW QUARTER SECTION 9, T.34N., R.2E., W.M. | |
| MADRONA VIEW ADD. TO SIMILK BEACH SKAGIT COUNTY, WASHINGTON | |
| FOR DENNY ONSLOW & SANDY CHURCH | |
| DRWG: 0839-ros2.dwg | DATE: JUNE, 2006 |
| FLD BOOK: 117 | SCALE: 1" = 30' |
| | SHEET 1 OF 1 |
| | JOB NO. 06.0839 |