

Return to:



200701220182
Skagit County Auditor

1/22/2007 Page 1 of 2 2:51PM

PROTECTED CRITICAL AREA SITE PLAN

Page 1 of 2

Grantor/Owner: Donald Stromberg

Grantee: PUBLIC

Site Address: 7040 Channel View Drive

Property ID #: P69134 Assessors Tax Account #: 3999-000-003-0004

Legal Description: Sec. 08 Twp. 35 Rng. 02 / Plat Name: Shore Ac Add to Guemes Is Lot: 3

Permit/Activity #: BP06-1284

The PROTECTED CRITICAL AREA (PCA) is to be left undisturbed in its natural state. "With the exception of activities identified as Allowed without Standard review under SCC 14.24.100, any land-use activity that can impair the functions and values of critical areas or their buffers through a development activity or by disturbance of the soil or water, and/or by removal of, or damage to, existing vegetation shall require critical areas review and written authorization pursuant to SCC 14.24." SCC 14.24.060 No clearing, grading, filling, logging or removal of woody material, building, construction or road construction of any kind, planting of non-native vegetation or grazing of livestock is allowed within the PCA areas except as specifically permitted by Skagit County on a case-by-case basis consistent with SCC 14.24.

Representations on this site plan may be approximations only and should not be used for purposes other than for determining general locations of critical areas. Development activities beyond the scope of this plan may require additional studies and approvals.

The above references to "Grantor" and "Grantee" shall not be construed as a transfer of property ownership and are used solely for filing with the County Auditor.

Owner: Donald B. Stromberg Date: 01-17-07

On this day personally appeared before me DONALD B. STROMBERG known to be the individual described herein and acknowledged to me that he signed the same as his free and voluntary act and deed for the uses and purposes therein mentioned.

Mary Joanne Ostlund, Notary Public in and for the State of Washington,
residing at 2423 1st St Date: January 17, 2007

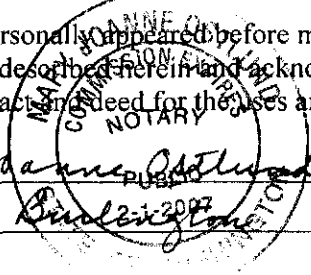

CRITICAL AREA SITE PLAN

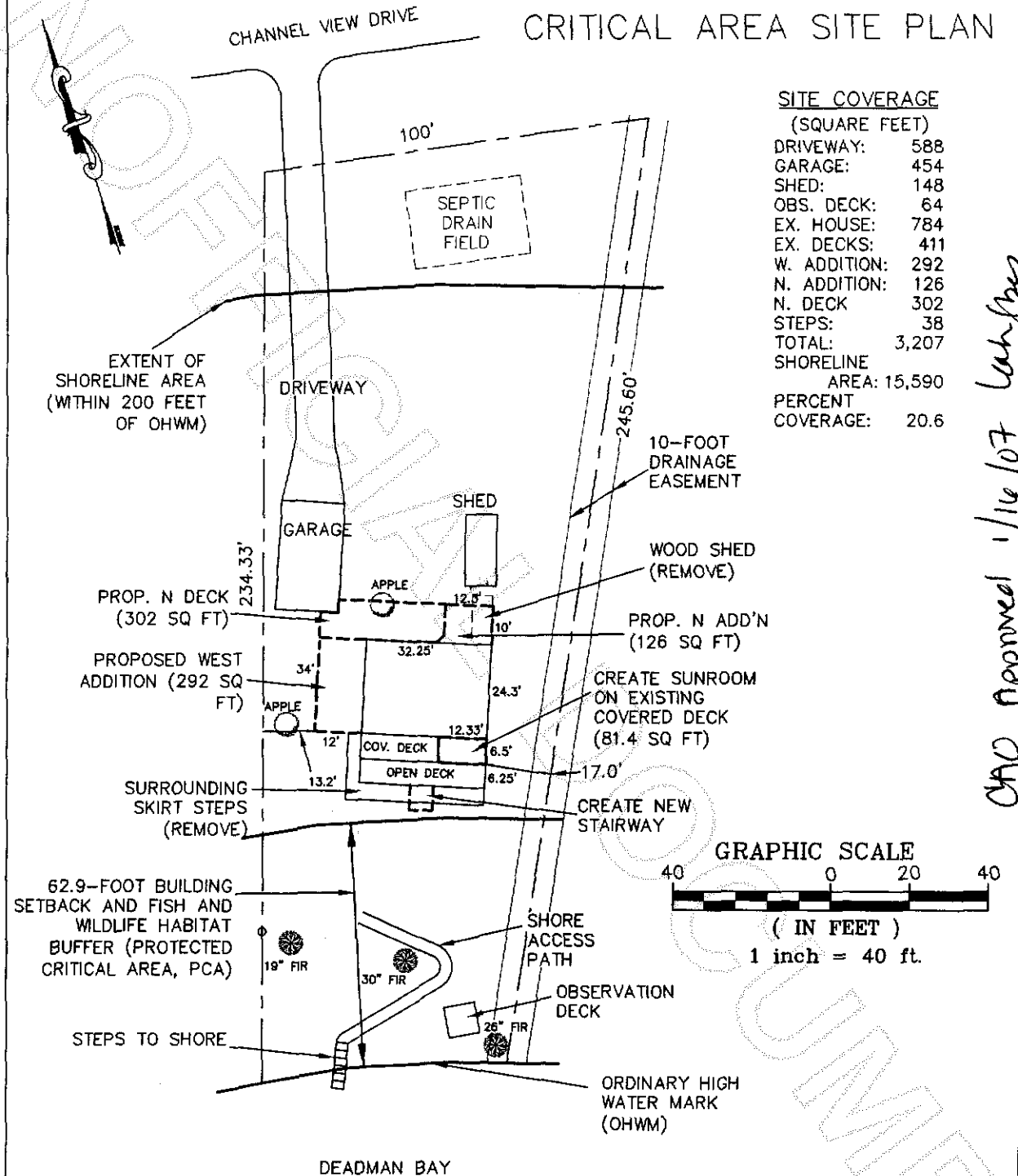

SITE COVERAGE
(SQUARE FEET)

DRIVEWAY:	588
GARAGE:	454
SHED:	148
OBS. DECK:	64
EX. HOUSE:	784
EX. DECKS:	411
W. ADDITION:	292
N. ADDITION:	126
N. DECK:	302
STEPS:	38
TOTAL:	3,207
SHORELINE AREA:	15,590
PERCENT COVERAGE:	20.6

CAG Approved 1/16/07 *Carly Spies*

Owners: D. Stromberg
 Address: 7040 Channel View
 Parcel: P69134
 Permit: BP06-1284
 Preparer: Edison Engineering
 Date: December 2006

This drawing was created with a compass and tape measure and is approximate.
NOT A SURVEY



200701220182
 Skagit County Auditor