

Return to:

Kent Van Egdom
2603 Washington Blvd
Anacortes, WA 98221



200801310001
Skagit County Auditor

1/31/2008 Page

1 of

2 8:37AM

PROTECTED CRITICAL AREA SITE PLAN

Page 1 of 2

Grantor/Owner: Kent & Anna VanEgdom

Grantee: PUBLIC

Site Address: NHN Whitecap Lane

Property ID #: P68048

Assessors Tax Account #: 3973-000-005-0002

Legal Description: Sec. 02 Twp. 34 Rng. 01 / Plat Name: Rancho San Juan Del Mar Div 2

Lot: 5

Permit/Activity #: PL05-0912

The PROTECTED CRITICAL AREA (PCA) is to be left undisturbed in its natural state. "With the exception of activities identified as Allowed without Standard review under SCC 14.24.100, any land-use activity that can impair the functions and values of critical areas or their buffers through a development activity or by disturbance of the soil or water, and/or by removal of, or damage to, existing vegetation shall require critical areas review and written authorization pursuant to SCC 14.24." SCC 14.24.060 No clearing, grading, filling, logging or removal of woody material, building, construction or road construction of any kind, planting of non-native vegetation or grazing of livestock is allowed within the PCA areas except as specifically permitted by Skagit County on a case-by-case basis consistent with SCC 14.24.

Representations on this site plan may be approximations only and should not be used for purposes other than for determining general locations of critical areas. Development activities beyond the scope of this plan may require additional studies and approvals.

The above references to "Grantor" and "Grantee" shall not be construed as a transfer of property ownership and are used solely for filing with the County Auditor.

Owner: Kent VanEgdom Date: Jan 17/08

On this day personally appeared before me Kent Van Egdom known to be the individual described herein and acknowledged to me that he signed the same as his free and voluntary act and deed for the uses and purposes therein mentioned.

Kathryn L. Sharp
residing at Skagit Co. Date: 1-17-08

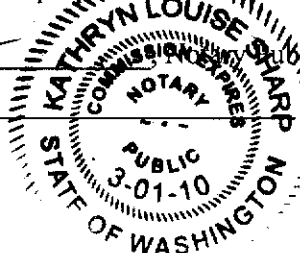

CAC Approved 1/20/06

Leah Sires

CRITICAL AREA SITE PLAN

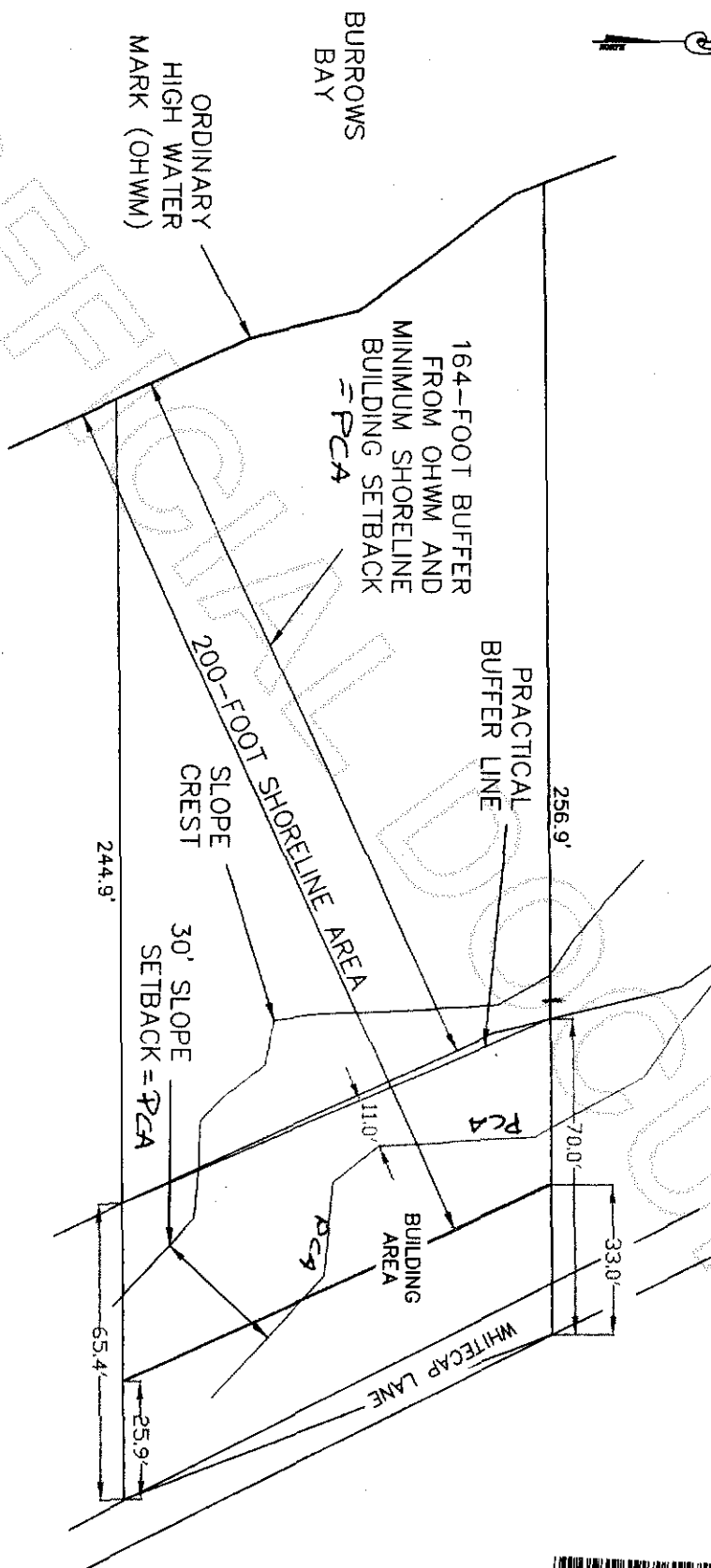

GRAPHIC SCALE
(IN FEET)
1 inch = 40 ft.

Owners: Kent & Anna Van Egdom
Address: Whitecap Lane
Parcel: P68048
Permit: PLOS-0289/PLOS-012
Preparer: Edison Engineering
Date: October 2005

This drawing was created by the project geologist and then scanned and modified to create the Critical Area Site Plan. It is approximate.
NOT A SURVEY



200801310001

Skagit County Auditor