

Return to:



200805150090  
Skagit County Auditor

5/15/2008 Page 1 of 2 2:12PM

**PROTECTED CRITICAL AREA SITE PLAN**

Page 1 of 2

Grantor/Owner: Robin Stroud

Grantee: PUBLIC

Site Address: Lot 56 35304 Shangri-La Dr. S-W

Property ID #: P 69050 Assessors Tax Account #: 3996-000-056-0003

Legal Description: Sec. 13 Twp. 35 Rng. 06 / Plat Name Shangri-La Lot 56

Permit/Activity #: SW08-0179

The PROTECTED CRITICAL AREA (PCA) is to be left undisturbed in its natural state. "With the exception of activities identified as Allowed without Standard review under SCC 14.24.100, any land-use activity that can impair the functions and values of critical areas or their buffers through a development activity or by disturbance of the soil or water, and/or by removal of, or damage to, existing vegetation shall require critical areas review and written authorization pursuant to SCC 14.24." SCC 14.24.060 No clearing, grading, filling, logging or removal of woody material, building, construction or road construction of any kind, planting of non-native vegetation or grazing of livestock is allowed within the PCA areas except as specifically permitted by Skagit County on a case-by-case basis consistent with SCC 14.24.

Representations on this site plan may be approximations only and should not be used for purposes other than for determining general locations of critical areas. Development activities beyond the scope of this plan may require additional studies and approvals.

The above references to "Grantor" and "Grantee" shall not be construed as a transfer of property ownership and are used solely for filing with the County Auditor.

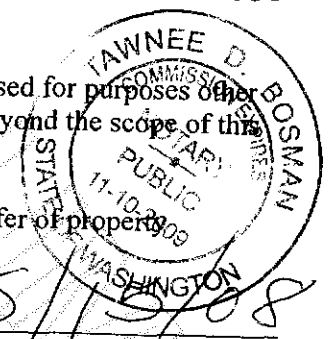

Owner: Robin Stroud Date: 5/15/08

On this day personally appeared before me ZOBINI D. STROUD known to be the individual described herein and acknowledged to me that SHE signed the same as HER free and voluntary act and deed for the uses and purposes therein mentioned.

Tawnee D. Bosman, Notary Public in and for the State of Washington, residing at MOUNT WASHINGTON Date: 11.10.2009

PROTECTED CRITICAL AREA SITE PLAN

Page 2 of 2

Applicant: MARK DOWLEY

Permit #:

Parcel #: 69050

Site Address: 35304 SHANORI-LA DR.

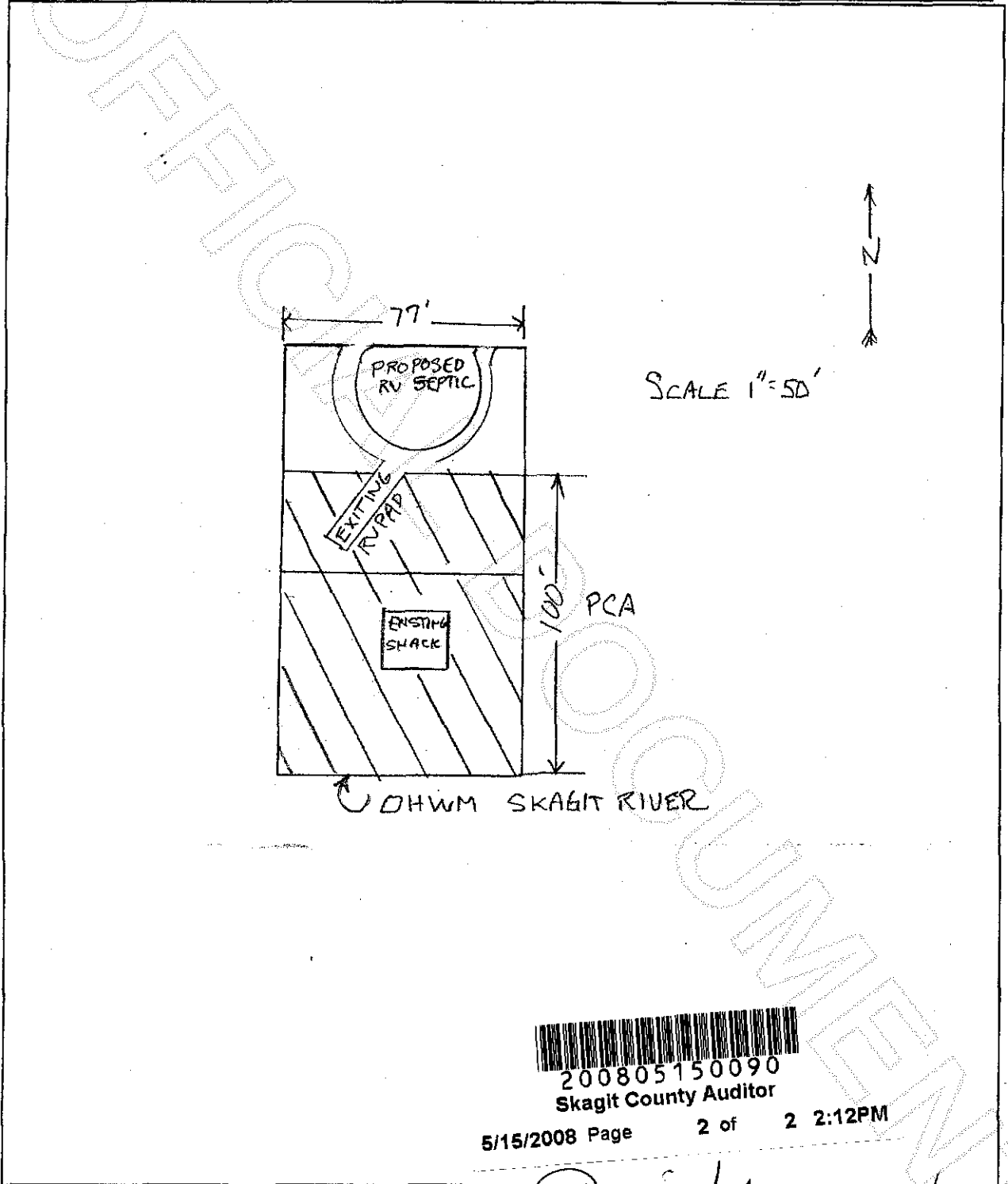

200805150090  
Skagit County Auditor

5/15/2008 Page 2 of 2 2:12PM

Adam  
Skagit County CAO Staff Signature

5.15.08  
Date

Robert Stroud  
Applicant Signature

5/15/08  
Date