

MONUMENT IN CASE
10' SOUTH OF
INTERSECTION
BROADWAY STREET

N 00°01'11" E 329.95'

THIRD STREET

SURVEYOR'S CERTIFICATE
THIS MAP CORRECTLY REPRESENTS A SURVEY MADE BY ME OR UNDER MY DIRECTION IN CONFORMANCE WITH THE REQUIREMENTS OF THE SURVEY RECORDING ACT AT THE REQUEST OF RUSS REHM

JOHN B. SEMRAU, P.E., P.L.S., CERTIFICATE NO. 28626
SEMRAU ENGINEERING & SURVEYING, P.L.L.C.
2118 RIVERSIDE DRIVE SUITE 208
MOUNT VERNON, WA 98273
PHONE 360-424-9566

DATE: 6-24-09

SOUTHEAST
CORNER
SECTION 19-34-4
MONUMENT IN
CASE (JULY 2004)

6-24-09

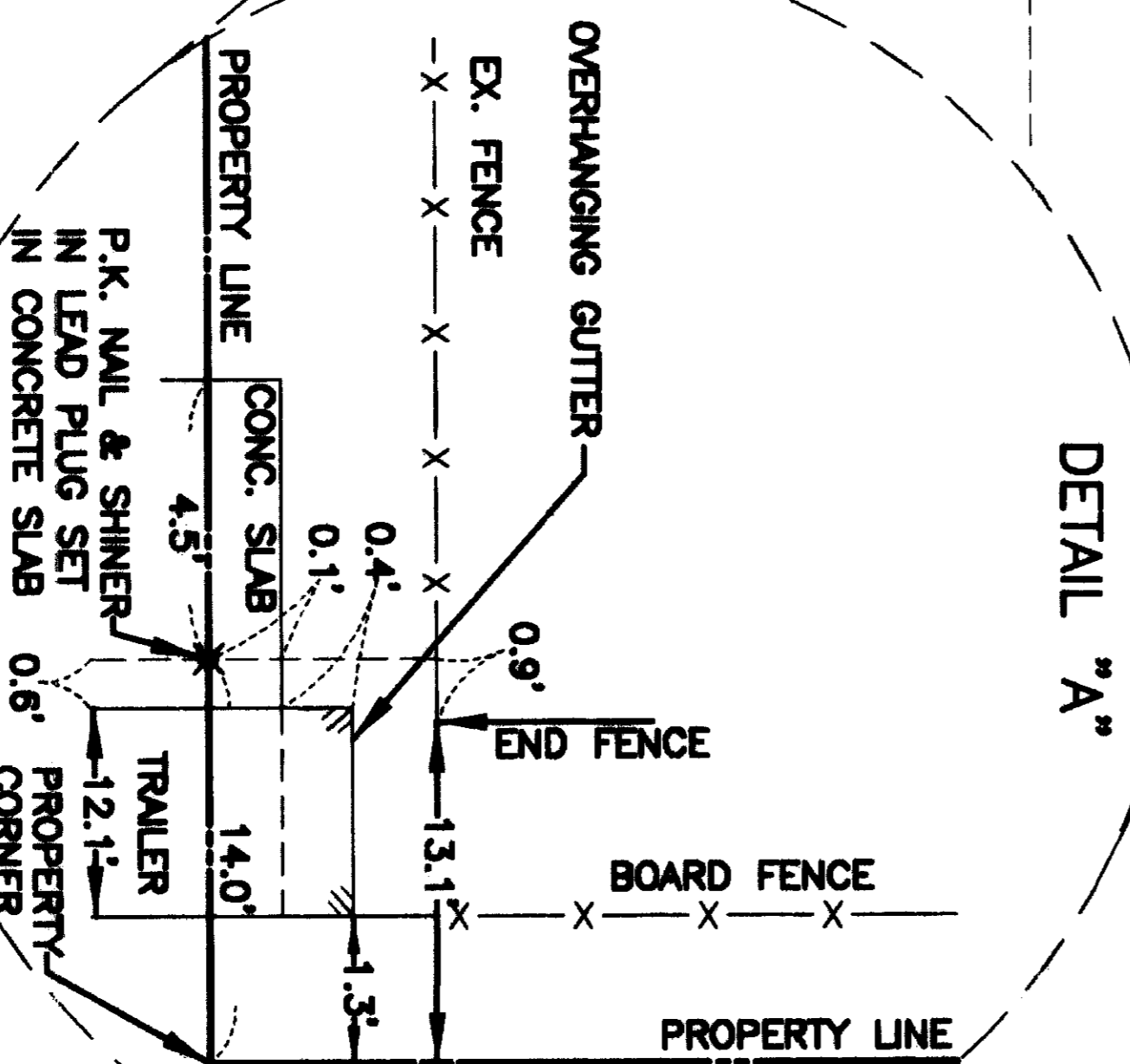
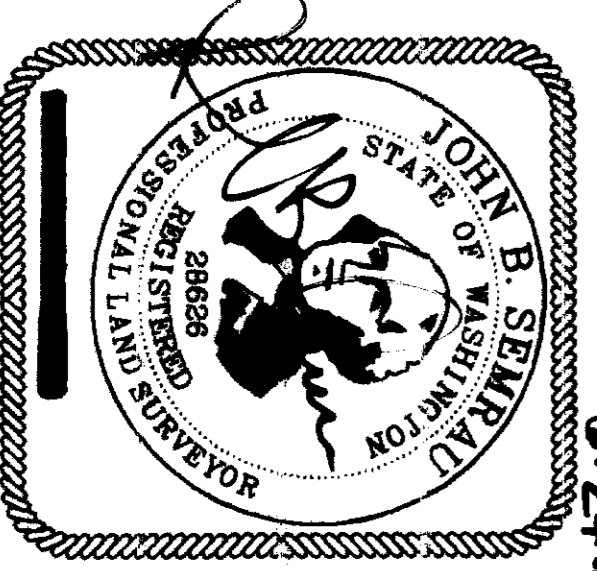

RC5
2004035050150
AFN

AUDITOR'S CERTIFICATE

2009062350068
Skagit County Auditor
6/25/2009 Page 1 of 1 1:10:25AM

AT THE REQUEST OF SEMRAU ENGINEERING & SURVEYING P.L.L.C.

J. Youngquist
AUDITOR
SKAGIT COUNTY

M. J. J. J.
DEPUTY
AUDITOR

NOTES

- - INDICATES REBAR SET, SEMRAU 28626
- ⊗ - INDICATES NAIL AND SHINER SET IN LEAD, SEMRAU 28626
- ⊗ - INDICATES MONUMENT FOUND
- THE DESCRIPTION FOR THIS SURVEY IS FROM STATUTORY WARRANTY DEED, SKAGIT COUNTY AUDITOR FILE NUMBER 200609290290.
- BASIS OF BEARING: EXISTING MONUMENTS FOUND ON CENTERLINE OF THIRD STREET AT BROADWAY STREET AND SNOQUALMIE STREET. BEARING = NORTH 00°01'11" EAST
- ALL DISTANCES ARE SHOWN IN FEET.
- INSTRUMENTATION: LEICA TCA 1105 THEODOLITE DISTANCE METER.
- SURVEY PROCEDURE: STANDARD FIELD TRAVERSE IN APRIL 2009.
- THIS SURVEY WAS REQUESTED BY RUSS REHM.
- THIS SURVEY MAY SHOW OCCUPATIONAL INDICATORS AS PER W.A.C. CHAPTER 332.130. LINES OF OCCUPATION MAY INDICATE AREAS FOR POTENTIAL CLAIMS OF UNWRITTEN OWNERSHIP. THIS BOUNDARY SURVEY HAS ONLY SHOWN THE RELATIONSHIP OF LINES OF OCCUPATION TO THE DEEDED LINES OF RECORD. NO RESOLUTION OF OWNERSHIP BASED ON UNWRITTEN RIGHTS HAS BEEN MADE OR IMPLIED BY THIS SURVEY.
- EXCEPT AS SPECIFICALLY STATED OR SHOWN ON THIS SURVEY MAP, THIS SURVEY DOES NOT PURPORT TO REFLECT ALL OF THE FOLLOWING WHICH MAY BE APPLICABLE TO THE SUBJECT REAL ESTATE: EASEMENTS, BUILDING SETBACK LINES, RESTRICTIVE COVENANTS, SUBDIVISION RESTRICTIONS, ZONING OR OTHER LAND-USE REGULATIONS AND ANY OTHER FACTS THAT AN ACCURATE AND CURRENT TITLE SEARCH MAY DISCLOSE.

DESCRIPTION

NORTH ½ OF LOTS 9 AND 10, BLOCK 4, "RIVERSIDE ADDITION TO THE TOWN OF MOUNT VERNON," AS PER PLAT RECORDED IN VOLUME 2 AND 3 OF PLATS, PAGES 78 AND 24, RESPECTIVELY, RECORDS OF SKAGIT COUNTY, WASHINGTON.
SITUATE IN THE CITY OF MOUNT VERNON, COUNTY OF SKAGIT, STATE OF WASHINGTON.

SURVEYOR'S NOTE

THIS PROPERTY AND OTHER PROPERTIES IN BLOCKS 3 AND 4, "RIVERSIDE ADDITION TO THE TOWN OF MOUNT VERNON," WERE SURVEYED BY LEGRO AND JUDY IN 1962, 1966, 1971 AND 1978. ALL OF THESE SURVEYS WERE STAKED PLAT DISTANCE FROM THIRD STREET.

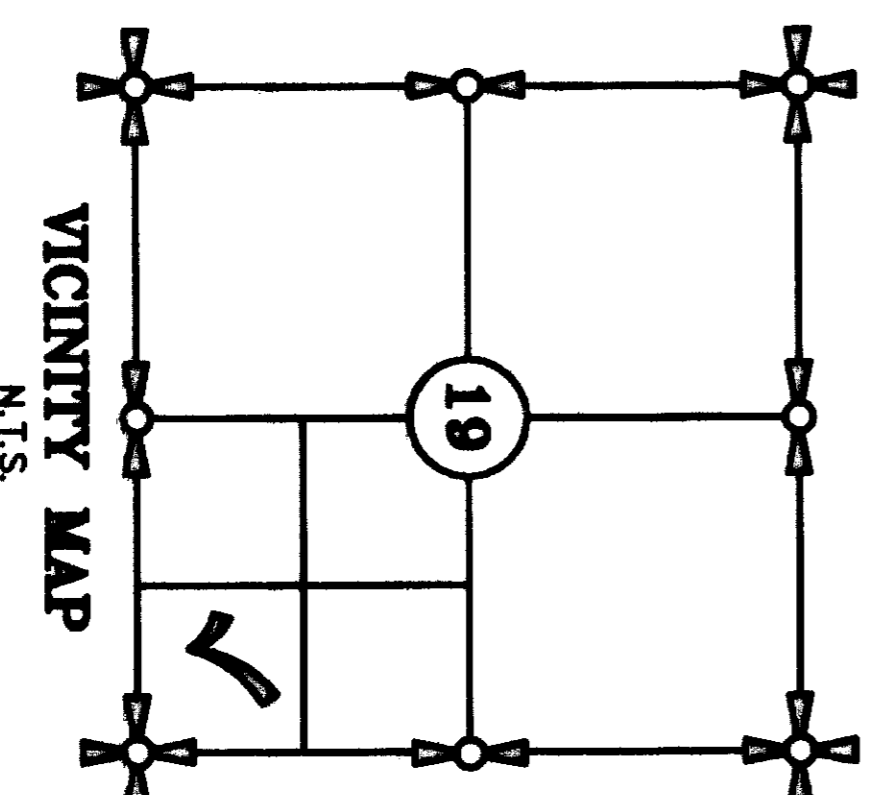

SHEET 1 OF 1

SURVEY OF PORTION OF LOTS 9 & 10, BLOCK 4, IN

RIVERSIDE ADD. TO TOWN OF MOUNT VERNON

SECTION 19, T. 34 N., R. 4 E., W.M.

FOR: RUSS REHM

FB. 273 Pg. 46-48 SEMRAU ENGINEERING & SURVEYING SCALE: 1" = 20'
MERIDIAN: ASSUMED SURVEYING • ENGINEERING • PLANNING MOUNT VERNON, WA 98273 360-424-9566 JOB NO. 4903