



201006230042
Skagit County Auditor

6/23/2010 Page 1 of 4 11:01AM

After recording return to:
P. Anne Austin and Keith Magnuson
14074 Edgewater Ln NE
Seattle, WA 98125

DECLARATION OF EASEMENT

The undersigned GRANTOR(S): Natalie Plecque (a married woman – as her separate estate), as owners in fee simple of that certain real property described as follows:

(0.1000 ac) SOUND VIEW TO SIMILK BEACH LOT 6 BLK 2

Tax Account No. **P69338**

Do hereby give, grant and convey to the GRANTEE(S): P. Anne Austin and Keith Magnuson, their heirs, successors and assigns, as interest holders of that certain real property described as follows:

(0.1800 ac) SOUND VIEW TO SIMILK BEACH, ACRES 0.18, LOTS 7 AND 8, BLOCK 2, SOUND VIEW TO SIMILK BEACH LOTS 7 AND 8, BLOCK 2, SOUND VIEW TO SIMILK BEACH

Tax Account No. **P69339**

A permanent exclusive EASEMENT to maintain that certain septic/drain field appurtenant to grantee's property which encroaches upon the grantor's property over, **as delineated on Exhibit "B" map attached hereto:**

Exhibit B (site plan page 3 of 3) is attached.

And the grantor's hereby declare that said easement shall be deemed to be a covenant running with the land, and shall bind the grantor's heirs, successors and assigns, and the grantor's property is to be held, sold and conveyed subject to said easement for the exclusive use and benefit of the interest holders of the real property of said grantees.

In witness whereof, the undersigned grantor(s) have set their hands on the 28 day of May, 2010.

GRANTOR:

Natalie M Plecque
Natalie M. Plecque

5/28/2010

SKAGIT COUNTY WASHINGTON
REAL ESTATE EXCISE TAX

Easement
JUN 23 2010

Amount Paid \$ 0
Skagit Co. Treasurer
By WMA Deputy

And the grantee(s) do hereby agree that no claims shall be made by said encroaching party, their heirs, successors and assigns, by virtue of adverse possession or eminent domain, and that they do not intend to claim title to any real property beyond their true boundary line.

CALIFORNIA ALL-PURPOSE ACKNOWLEDGMENT

State of California

County of Santa Clara }

On May 28, 2010 before me, Elena Ramirez, Notary

personally appeared Natalie Michelle Plecque
Date Here Insert Name and Title of the Officer Name(s) of Signer(s)

who proved to me on the basis of satisfactory evidence to be the person(s) whose name(s) is/are subscribed to the within instrument and acknowledged to me that he/she/they executed the same in his/her/their authorized capacity(ies), and that by his/her/their signature(s) on the instrument the person(s), or the entity upon behalf of which the person(s) acted, executed the instrument.



I certify under PENALTY OF PERJURY under the laws of the State of California that the foregoing paragraph is true and correct.

WITNESS my hand and official seal.

Signature Elena Ramirez
Signature of Notary Public

Place Notary Seal Above

OPTIONAL

Though the information below is not required by law, it may prove valuable to persons relying on the document and could prevent fraudulent removal and reattachment of this form to another document.

Description of Attached Document State of WA # P69338

Title or Type of Document: Declaration of Easement # P69339

Document Date: 5-28-10 Number of Pages: 1

Signer(s) Other Than Named Above: none

Capacity(ies) Claimed by Signer(s)

Signer's Name: Natalie M Plecque

- Individual
- Corporate Officer — Title(s): _____
- Partner — Limited General
- Attorney in Fact
- Trustee
- Guardian or Conservator
- Other: _____



Signer Is Representing: [Signature]

Signer's Name: _____

- Individual
- Corporate Officer — Title(s): _____
- Partner — Limited General
- Attorney in Fact
- Trustee
- Guardian or Conservator
- Other: _____



Signer Is Representing: _____



201006230042
Skagit County Auditor

In witness whereof, the undersigned grantee's have hereunto set their hands on the 28th day of May, 2010.

GRANTEE: [Signature]
P. Anne Austin

GRANTEE: [Signature]
Keith Magnuson

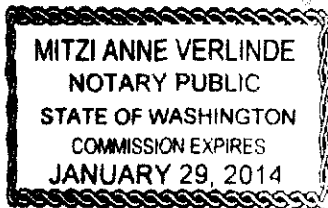

x [Signature]

State of Washington
County of KING
On May 28, 2010
before me, P. Annie Austin
and Keith Magnuson
personally appeared before
me Mitzi Anne Verlinde,
Notary.



201006230042
Skagit County Auditor

EXHIBIT "B"

MAY-06-2010 13:07

JOHN L SCOTT ANACORTES

13602935605

P.002

SITE PLAN, 13443 DRIVER ROAD

Property ID: P69339 & P69338

Designer: Linda Spicher

Page 3 of 3

THIS IS NOT A SURVEY.

CALL FOR A UTILITY LOCATE PRIOR TO THE START OF CONSTRUCTION, (800) 424-5555.

SITE, DESIGN & CONSTRUCTION REQUIREMENTS NOT SPECIFICALLY MENTIONED HEREIN SHALL CONFORM TO APPLICABLE COUNTY & STATE STANDARDS.

AS-BUILT
08/15/09

THIS SYSTEM REQUIRES
SEMI-ANNUAL MAINTENANCE.

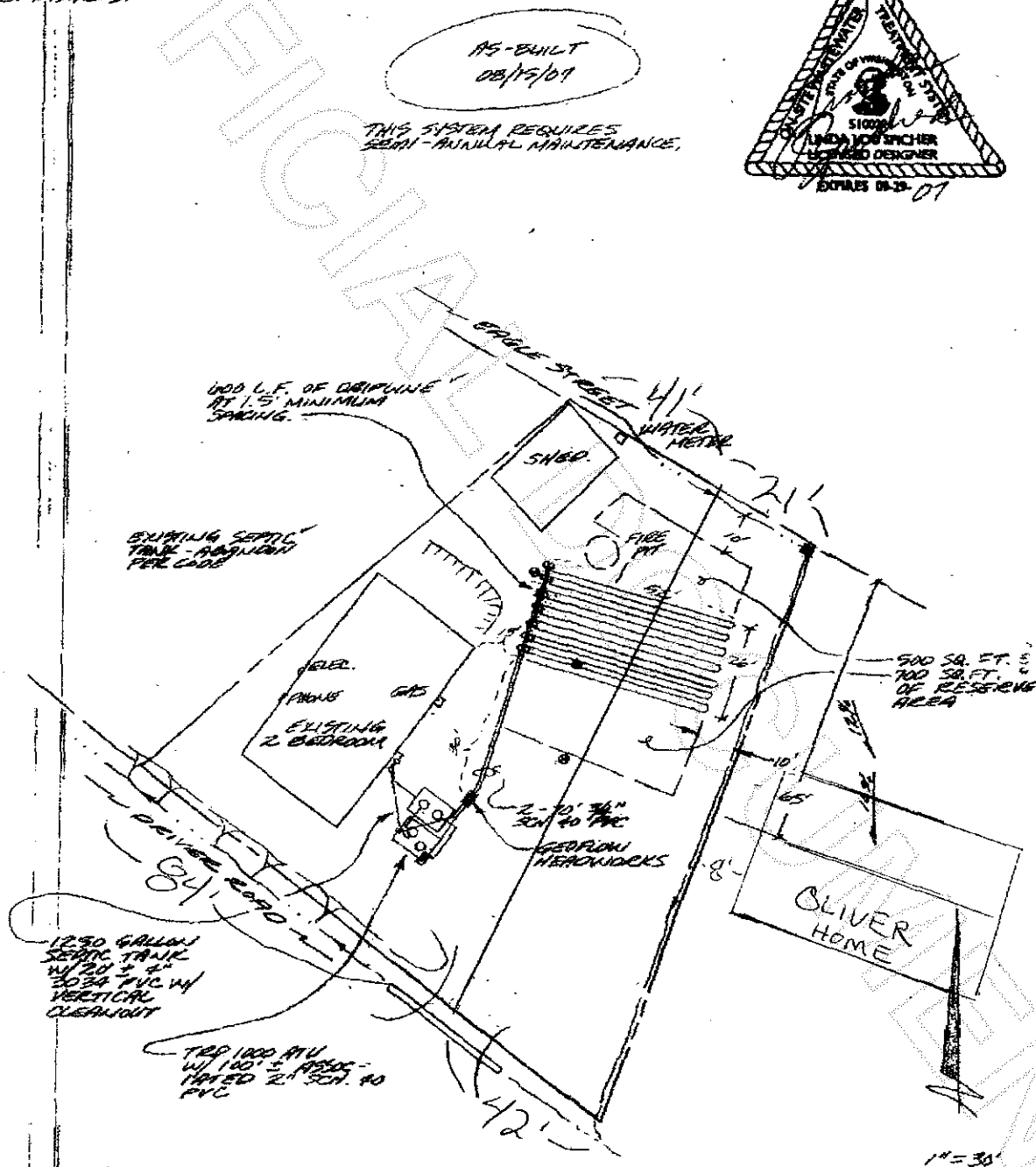
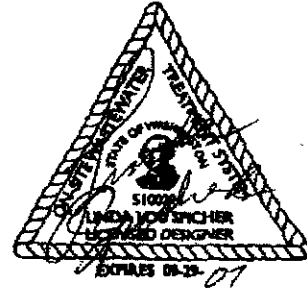

201006230042
Skagit County Auditor