

Return to:

Donald Berkey

2503 60th St. SE

Everett, WA 98203-4071



201102220207

Skagit County Auditor

2/22/2011 Page

1 of

3 3:40PM

PROTECTED CRITICAL AREA SITE PLAN

Grantor/Owner: Donald and Jean Berkey

Grantee: PUBLIC

Site Address: 15885 Yokeko Drive, Anacortes, WA 98221

Property ID #: P64867

Assessors Tax Account #: 3898-000-005-0004

Legal Description: Sec. 24 Twp. 34 Range 1 Plat Name: Deception Pass Waterfront Tracts, Lot 4 and West ½ of Lot 5

Permit/Activity #: PL05-0914 Shoreline variance

The PROTECTED CRITICAL AREA (PCA) is to be left undisturbed in its natural state. "With the exception of activities identified as Allowed without Standard review under SCC 14.24.070, any land-use activity that can impair the functions and values of critical areas or their buffers through a development activity or by disturbance of the soil or water, and/or by removal of, or damage to, existing vegetation shall require critical areas review and written authorization pursuant to SCC 14.24." SCC 14.24.060

No clearing, grading, filling, logging or removal of woody material, building, construction or road construction of any kind, planting of non-native vegetation or grazing of livestock is allowed within the PCA areas except as specifically permitted by Skagit County on a case-by-case basis consistent with SCC 14.24.

Representations on this site plan may be approximations only and should not be used for purposes other than for determining general locations of critical areas. Development activities beyond the scope of this plan may require additional studies and approvals.

The above references to "Grantor" and "Grantee" shall not be construed as a transfer of property ownership and are used solely for filing with the County Auditor.

Owner: Donald L. Berkey Date: FEB. 9, 2011

On this day personally appeared before me Donald L. Berkey known to be the individual described herein and acknowledged to me that He signed the same as His free and voluntary act and deed for the uses and purposes therein mentioned.

Shannon M. Axman Notary Public in and for the State of Washington,
residing at Arlington, WA Date: 2/9/2011

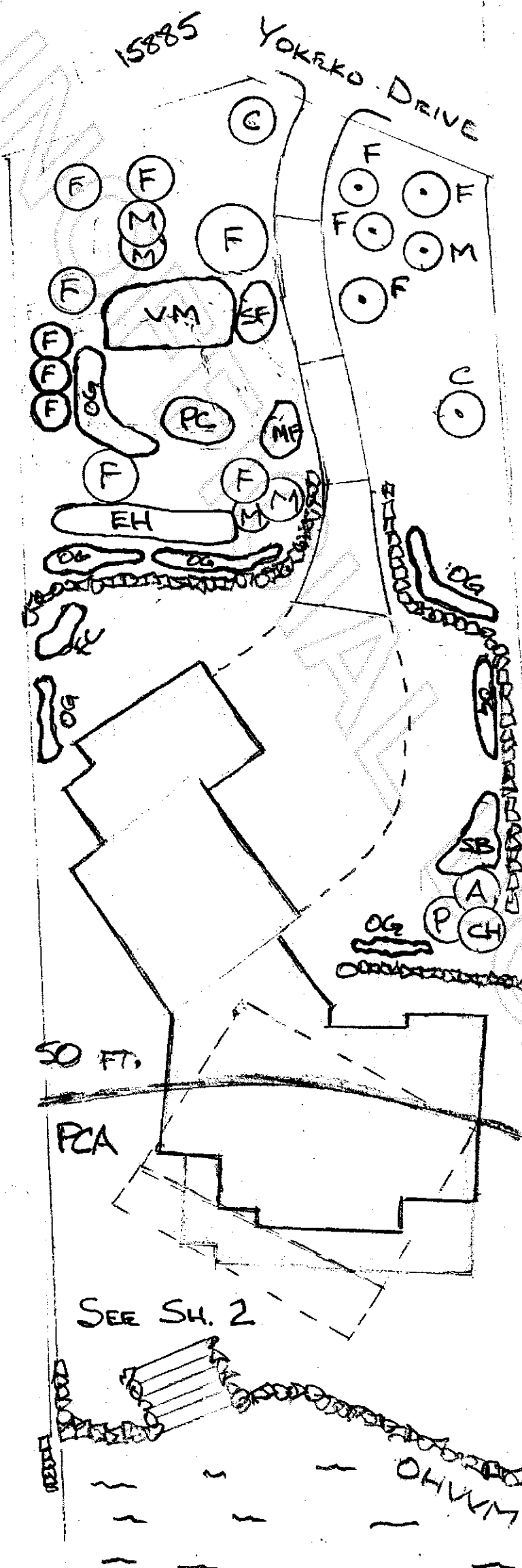

LANDSCAPE PLAN

Parcel # P64867

Permit # PL05-0914

Donald and Jean Berkey

Jan. 30, 2011

Plant List

Symbol	Name
A	Apple
BH	Bleeding Heart
C	Western Red Cedar
CH	Cherry
CL	Evergreen Clematis
D	Douglas Fir
DA	Douglas Aster
EH	Evergreen Huckleberry
FC	Franchet's Cotoneaster
K	Kinnickinick
M	Madrone
MF	Maidenhair Fern
OG	Oregon Grape
OS	Ocean Spray
P	Plum
PC	Pacific Crabapple
SB	Common Snowberry
SD	Seaside Daisy
SF	Sword Fern
SP	Shore Pine
RTD	Red Twig Dogwood
VM	Vine Maple

CAO approval Betsy Stevenson
2/9/11

PCA Boundary

50 FT.

N

SCALE: 1"=20'
SHEET 1 of 2



201102220207
Skagit County Auditor

2/22/2011 Page 3 of 3 3:40PM