

Cased monument
(cover destroyed)

No monument found as shown on adjoining survey per AFN 201101250053 prepared for MJB Properties

LEGEND
All symbols shown are identified in place on the drawing

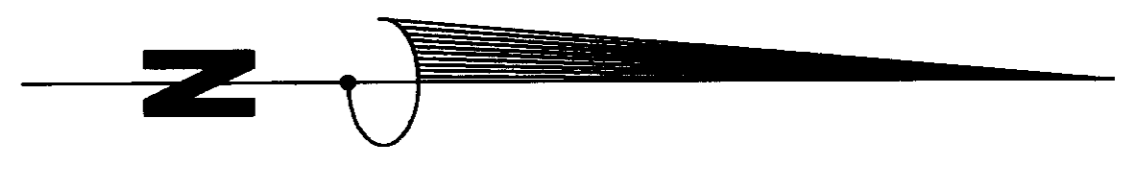
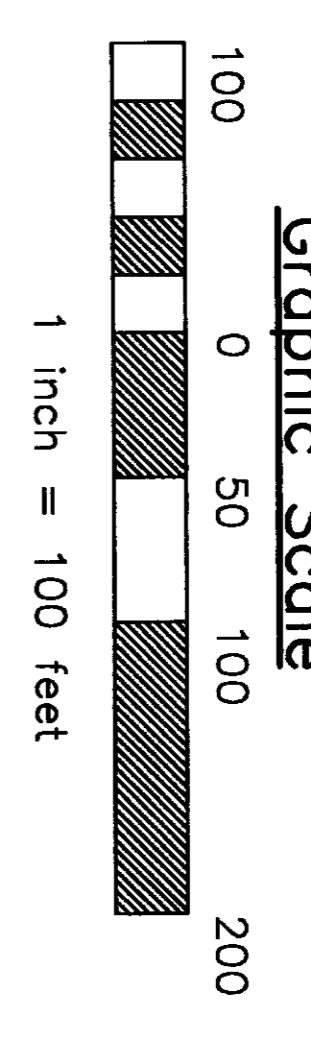

LEASE NO. 22-084216

A lease area for boat storage over a portion of State Owned Aquatic Lands within Anacortes Harbor which lies seaward of First Class Tidelands Tracts 29 and 30, a portion of Tract 28 and Vacated 27th, 28th and 29th Streets as shown on Plate 10 of Anacortes Harbor in Section 19, Township 35 North, Range 2 East, W.M., City of Anacortes, Skagit County, Washington; lying seaward of Government Lot 1, Section 19 in Township 35 North, Range 2 East, W.M. described as follows:

Commencing at the southwest corner of said Section 19 as shown on "A survey of Anacortes Harbor Lines" recorded under Auditor's File Number 200110030106, records of Skagit County, Washington; thence proceeding along the south line of said section as shown on said survey S88°03'11"E 2191.23 feet to the east meander corner; thence continuing S88°03'11"E, 606.67 feet to a point on the inner harbor line and the true point of beginning; thence along said inner harbor line N28°28'51"W, 751.41 feet; thence along said inner harbor line N01°18'10"E, 37.37 feet; thence along the following eight courses: (1) S84°41'45"E, 127.88 feet; (2) S68°38'11"E, 172.45 feet; (3) S53°16'29"E, 145.97 feet; (4) S42°33'40"E, 117.40 feet; (5) S30°29'35"E, 122.29 feet; (6) S17°37'49"E, 113.71 feet; (7) S11°14'13"E 113.27 feet; (8) S02°30'44"E, 133.28 feet to a point on the south boundary of said tract as shown on that survey recorded under Auditor's File Number 9010110009, records of said county, from which a rebor and cap, marked "LS 8992" bears N88°03'11"W, 27.43 feet; thence along said boundary N88°03'11"W, 251.41 feet to the true point of beginning and from which a rebor and cap marked "LS 8992" bears S88°03'11"E, 12.39 feet.

Tidal Elevations per Army Corps Provisional Data
Highest Estimated Tide 11.0 ±0.5' (MLLW = 0.0)
Mean Higher High Water 7.67' (NGVD'88)
Mean High Water 6.87
Mean Low Water 1.87
Mean Lower Low Water -0.63'
Lowest Estimated Tide -4.5 ±0.5'

Reference tie to Section Corner
This survey has been prepared using static GPS receivers and terrestrial instruments.

The Southwest Section Corner and the Monument at 30th and T Avenue shown on the DNR Harbor Lines survey, AFN 200110030106, are the controlling positions for determination of the section line and the harbor lines.
The purpose of this survey has been to describe the lease area shown for boat storage.
There may be a conflict with Lease No. 23-081351 held by the City of Anacortes for fireworks display.

Cased monument at 28th and T Avenue
Elevation = 24.9' NGVD'88
N 551972.2223
E 1210521.8498

Section Corner, Visited 10-04-11. Found per record. Position per Harbor Lines Survey AFN 2000110030106
GRID N:551740.650
E:1208697.930
LATITUDE: 48°29'55.845"
LONGITUDE: -122°36'50.780"

VERTICAL DATUM
Elevations are based on observation of NGS Brass Tablet No. S-329, 1952, located at the Southeast corner of Commercial Ave and 28th St. NGVD '88 = 70.31'

Section 19
Section 30
BASIS OF BEARINGS
Meander Corner (not visited this survey, shown per AFN 200110030106)

Cased monument, 30th and T, Also Point # 502 per Harbor Line Survey, AFN 2000110030106
GRID N:551381.144
E:1210502.533
LATITUDE: 48°29'52.710"
LONGITUDE: -122°36'23.869"

BOAT STORAGE AREA
Lease No. 22-084216
Tract 2, Parcel S per Survey of Anacortes Industrial Park, AFN 9010110009
5.11 acres
222,396 sq. ft.

EASTERN BOUNDARY

LINE	LENGTH	BEARING
L1	127.88	S84°41'45"E
L2	172.45	S68°38'11"E
L3	145.97	S53°16'29"E
L4	117.40	S42°33'40"E
L5	122.29	S30°29'35"E
L6	113.71	S17°37'49"E
L7	113.27	S11°14'13"E
L8	133.28	S02°30'44"E

NOTE: Dimensions along the eastern boundary generally follow the toe of a rip-rope bank.

** Distance between rebors, 224.41 per AFN 9010110009 and recent survey for MJB, AFN 201101250053

Surveyor's Certificate

This map correctly represents a survey made by me or under my direction in conformity with the requirements of the Survey Recording Act of the request of Bonarda Belt Boats, in Skagit County, Washington in October, 2011.

Robert J. Parsh
Certificate No. 29535

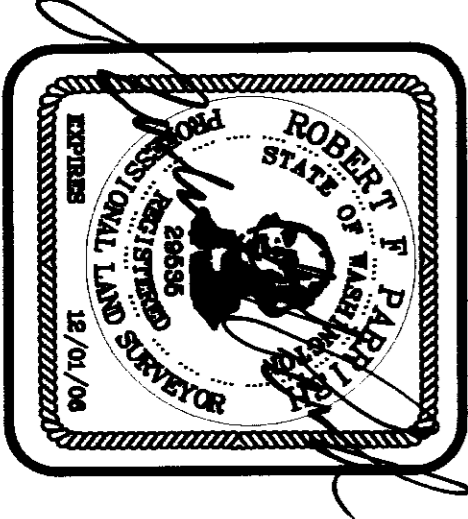

BOAT STORAGE AREA
Located Seaward of Gov't Lot 1, Sect. 19, T.35N., R.2E.

Parish Land Surveying
PO Box 314, Lopez, Washington 98261
Autocores (360) 588-1467 email parish@parishland.com

FILE NAME: 1108-580
SCALE: 1" = 100'
DATE OF PLAN: 11-22-11
DRAWN BY: RFP
F.B. No. 35
SECTION 19
TOWNSHIP 35N
RANGE 2E

Fidalgo Bay
Breckwater
Etidalga Marina
Survey per AFN 200311100222
Lease No. 22-002664

BANANA BELT BOATS
Aquatic Lease / Record of Survey

Prepared for:
BANANA BELT BOATS
Aquatic Lease / Record of Survey

12/27/2011 Page 1 of 1 11:37AM

20112270034
Skagit County Auditor
1 of 1