

Survey in the SE1/4 of the NW1/4 and in the SW1/4 of the NW1/4 of Section 33, Twp. 35 N., Rng. 5 E., W.M.

Legal Description – Stotts

PARCEL A: THE WEST HALF OF THE FOLLOWING DESCRIBED TRACT: TOWNSHIP 35 NORTH, RANGE 5 EAST OF THE WILLAMETTE MERIDIAN, MORE PARTICULARLY DESCRIBED AS FOLLOWS: COMMENCING AT THE NORTHWEST CORNER OF THE NORTHEAST QUARTER IN SAID SECTION 33; THENCE N 88°26'49"E ALONG THE NORTH LINE OF SAID SUBDIVISION 1378.13 FEET; THENCE S 00°33'37"E, 2,006.16 FEET; THENCE S 89°25'29"W, PARALLEL WITH THE EAST/WEST CENTERLINE OF SAID SECTION 33 FOR A DISTANCE OF 2,118.57 FEET TO THE TRUE POINT OF BEGINNING; THENCE CONTINUING S 89°25'29"W, 1,010.01 FEET; THENCE S 00°47'30"E 410.00 FEET; THENCE N 89°25'29"E, PARALLEL WITH THE EAST/WEST CENTERLINE, 1,010.01 FEET; THENCE N 00°47'30"W, 410.00 FEET TO THE TRUE POINT OF BEGINNING. (ALSO KNOWN AS TRACT 8 OF UNRECORDED SURVEY OF STEELHEAD BEND).

EXCEPT FROM THE ABOVE, THAT PORTION, IF ANY, LYING WITHIN TRACT 9, 10 AND 22 OF SAID UNRECORDED PLAT OF STEELHEAD BEND, AND AS CONVEYED BY INSTRUMENT RECORDED APRIL 16, 1973, AND MAY 11, 1973, UNDER AUDITOR'S FILE NOS. 783590 AND 784878, RECORDS OF SKAGIT COUNTY, WASHINGTON.

PARCEL B: AN EASEMENT 100 FEET IN WIDTH FOR INGRESS, EGRESS AND UTILITIES OVER ACROSS SECTION 33, TOWNSHIP 35 NORTH, RANGE 5 EAST OF THE WILLAMETTE MERIDIAN, THE CENTERLINE OF WHICH IS DESCRIBED AS FOLLOWS: BEGINNING AT THE EAST QUARTER CORNER OF SAID SECTION 33; THENCE S 89°25'29"E, ALONG THE EAST-WEST CENTERLINE OF SAID SECTION 33, A DISTANCE OF 1,000.00 FEET; THENCE S 03°00'16"W, 505.00 FEET, MORE OR LESS, TO A POINT ON THE NORTH LINE OF THE COUNTY ROAD KNOWN AS THE OLD DAY CREEK ROAD, SAID POINT ALSO BEING THE POINT OF BEGINNING OF HEREIN DESCRIBED CENTERLINE; THENCE N 03°00'16"E, 505.00 FEET, MORE OR LESS, TO THE EAST-WEST CENTERLINE OF SAID SECTION 33; THENCE CONTINUING N 03°00'16"E, 250.43 FEET; THENCE S 89°25'29"W, PARALLEL WITH SAID EAST-WEST CENTERLINE OF SECTION 33, A DISTANCE OF 420.00 FEET; THENCE N 00°33'37"E, 410.00 FEET; THENCE S 89°25'29"W, PARALLEL WITH SAID EAST-WEST CENTERLINE OF SECTION 33, A DISTANCE OF 2850.00 FEET TO THE TERMINUS OF HEREIN DESCRIBED CENTERLINE. ALL SITUATED IN SKAGIT COUNTY, WASHINGTON.

Legal Description – Farmer

PARCEL A: THE EAST HALF OF THE FOLLOWING DESCRIBED TRACT: TOWNSHIP 35 NORTH, RANGE 5 EAST OF THE WILLAMETTE MERIDIAN, MORE PARTICULARLY DESCRIBED AS FOLLOWS: COMMENCING AT THE NORTHWEST CORNER OF THE NORTHEAST QUARTER IN SAID SECTION 33; THENCE N 88°26'49"E ALONG THE NORTH LINE OF SAID SUBDIVISION 1378.13 FEET; THENCE S 00°33'37"E, 2,006.16 FEET; THENCE S 89°25'29"W, PARALLEL WITH THE EAST/WEST CENTERLINE OF SAID SECTION 33 FOR A DISTANCE OF 2,118.57 FEET TO THE TRUE POINT OF BEGINNING; THENCE CONTINUING S 89°25'29"W, 1,010.01 FEET; THENCE S 00°47'30"E 410.00 FEET; THENCE N 89°25'29"E, PARALLEL WITH THE EAST/WEST CENTERLINE, 1,010.01 FEET; THENCE N 00°47'30"W, 410.00 FEET TO THE TRUE POINT OF BEGINNING. (ALSO KNOWN AS TRACT 7 OF UNRECORDED SURVEY OF STEELHEAD BEND).

EXCEPT FROM THE ABOVE, THAT PORTION, IF ANY, LYING WITHIN TRACT 9, 10 AND 22 OF SAID UNRECORDED PLAT OF STEELHEAD BEND, AND AS CONVEYED BY INSTRUMENT RECORDED APRIL 16, 1973, AND MAY 11, 1973, UNDER AUDITOR'S FILE NOS. 783590 AND 784878, RECORDS OF SKAGIT COUNTY, WASHINGTON.

PARCEL B: AN EASEMENT 100 FEET IN WIDTH FOR INGRESS, EGRESS AND UTILITIES OVER ACROSS SECTION 33, TOWNSHIP 35 NORTH, RANGE 5 EAST OF THE WILLAMETTE MERIDIAN, THE CENTERLINE OF WHICH IS DESCRIBED AS FOLLOWS: BEGINNING AT THE EAST QUARTER CORNER OF SAID SECTION 33; THENCE S 89°25'29"E, ALONG THE EAST-WEST CENTERLINE OF SAID SECTION 33, A DISTANCE OF 1,000.00 FEET; THENCE S 03°00'16"W, 505.00 FEET, MORE OR LESS, TO A POINT ON THE NORTH LINE OF THE COUNTY ROAD KNOWN AS THE OLD DAY CREEK ROAD, SAID POINT ALSO BEING THE POINT OF BEGINNING OF HEREIN DESCRIBED CENTERLINE; THENCE N 03°00'16"E, 505.00 FEET, MORE OR LESS, TO THE EAST-WEST CENTERLINE OF SAID SECTION 33; THENCE CONTINUING N 03°00'16"E, 250.43 FEET; THENCE S 89°25'29"W, PARALLEL WITH SAID EAST-WEST CENTERLINE OF SECTION 33, A DISTANCE OF 420.00 FEET; THENCE N 00°33'37"E, 410.00 FEET; THENCE S 89°25'29"W, PARALLEL WITH SAID EAST-WEST CENTERLINE OF SECTION 33, A DISTANCE OF 2850.00 FEET TO THE TERMINUS OF HEREIN DESCRIBED CENTERLINE. ALL SITUATED IN SKAGIT COUNTY, WASHINGTON.

Notes

1. BASIS-OF-BEARINGS – ASSUMED N89°25'29"E ON THE SOUTH LINE OF THE NORTHWEST QUARTER OF SECTION 33.
2. THIS SURVEY WAS ACCOMPLISHED BY FIELD TRAVERSE USING: 5 SECOND OR BETTER DIGITAL ELECTRONIC TOTAL STATION, AND MEETS OR EXCEEDS THE STANDARDS CONTAINED IN WAC 332-130-090.
3. BOUNDARY SURVEYS REFLECT INFORMATION DISCOVERED BY THE SURVEYOR IN THE NORMAL COURSE OF WORK AND DO NOT NECESSARILY SHOW EVERY POSSIBLE CONDITION AFFECTING THE PROPERTY EASEMENTS, RESTRICTIONS, AND OTHER ENCUMBRANCES MAY EXIST WHICH ARE NOT SHOWN HEREON.

FOUND REINFORCING ROD, ACCEPTED, SET WHITE 2"x2" WITNESS STAKE.

SET REINFORCING ROD ON PROPERTY LINE AT END OF 100 FOOT WIDE EASEMENT DESCRIBED IN PARCEL B IN THE ABOVE LEGAL DESCRIPTIONS.

Stotts
4.75 ac.

Farmer
4.75 ac.

100 FOOT WIDE EASEMENT DESCRIBED IN PARCEL B IN THE ABOVE LEGAL DESCRIPTIONS.

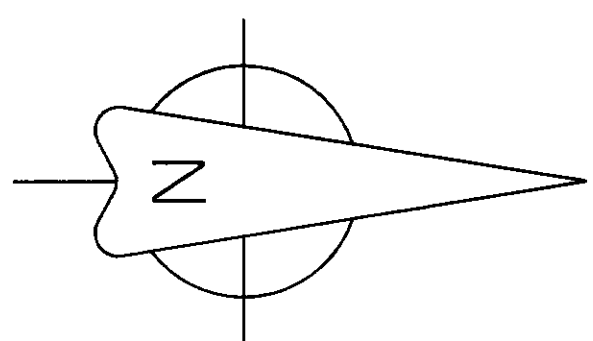

FOUND 2 1/2" IRON PIPE ON 2/28/79, SEE SURVEY FILED IN VOLUME 6 PAGE 219, A.F.#8605140054.

CENTER 1/4 AS SHOWN ON SURVEY FILED IN VOLUME 13 OF SURVEYS AT PAGE 28, A.F.#9207170211.



S89°25'29"W 2684.56'

Legend

- SET 1/2" x 18" REINFORCING ROD WITH YELLOW PLASTIC CAP MARKED "SKA SURV 17651" AND WHITE 2" x 2" WITNESS STAKE, EXCEPT AS NOTED.

Survey for Scott Farmer and William Stotts

Skagit Surveyors & Engineers

806 Metcalf St., Sedro-Woolley, WA 98284 Phone: (360) 855-2121 FAX: (360) 855-1658

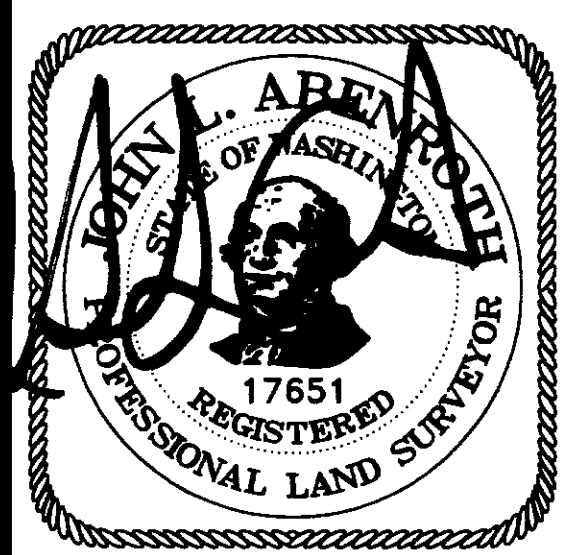

SURVEYOR'S CERTIFICATE
This map correctly represents a survey made by me or under my direction in conformance with the Survey Recording Act in December 2013 at the request of William Stotts and Scott Farmer.

John L. Abenroth CERT#17651
Date 2/9/14

AUDITOR'S CERTIFICATE
201402060028
Skagit County Auditor \$138.00
2/6/2014 Page 1 of 1 11:52AM

Witnessed by
County Auditor Deputy Auditor
J. Wangquist
D. Zavalza