

Return to:

John Cooper, LG LHG  
Skagit Cnty Planning & Devel. Svcs  
1800 Continental Pl Mt Vernon WA 98273



201602230041

**PROTECTED CRITICAL AREA SITE PLAN**

Page 1 of 2

Skagit County Auditor

\$74.00

2/23/2016 Page

1 of

2 12:49PM

Grantor/Owner: Mr. Walter Corbin

Grantee: PUBLIC

Site Address: 17 Appaloosa Lane, Lake Sammish

Property ID #: P47502 Assessors Tax Account #: 360301-0-005-0009

Legal Description: Sec. 1 Twp. 36 North Rng. 3 east, WM.

Permit/Activity #: BP15-0328

The PROTECTED CRITICAL AREA (PCA) is to be left undisturbed in its natural state. "With the exception of activities identified as Allowed without Standard review under SCC 14.24.070, any land-use activity that can impair the functions and values of critical areas or their buffers through a development activity or by disturbance of the soil or water, and/or by removal of, or damage to, existing vegetation shall require critical areas review and written authorization pursuant to SCC 14.24." SCC 14.24.060

No clearing, grading, filling, logging or removal of woody material, building, construction or road construction of any kind, planting of non-native vegetation or grazing of livestock is allowed within the PCA areas except as specifically permitted by Skagit County on a case-by-case basis consistent with SCC 14.24.

Representations on this site plan may be approximations only and should not be used for purposes other than for determining general locations of critical areas. Development activities beyond the scope of this plan may require additional studies and approvals.

The above references to "Grantor" and "Grantee" shall not be construed as a transfer of property ownership and are used solely for filing with the County Auditor.

Owner: [Signature] Date: 2/9/16

On this day personally appeared before me Walter Corbin, to me known to be the individual(s) described in and who executed the within and foregoing instrument, and acknowledged that he/she/they signed the same as his/her/their free and voluntary act and deed, for the uses and purposes therein mentioned.

Given under my hand and seal of office this 9th day of February, 2016

[Signature]  
Notary Public residing at

My Commission Expires: 10-21-18



WATER CO. LOT  
SUMMERLAND LANE

APPALOOSA LAKE

NULLE ROAD

LAKE SAMISH ROAD

CRITICAL AREA  
SITE PLAN

This area not investigated for critical areas & is considered PCA until CAO review is completed.

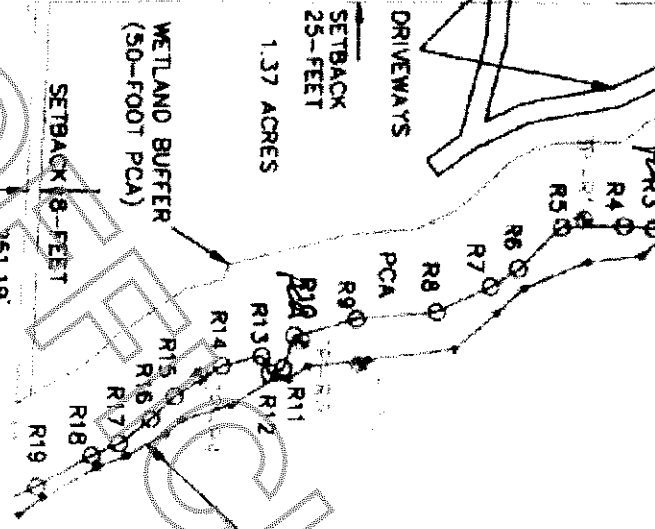

Owners: Walter Corbin  
Address: 17 Appaloosa Ln.  
Parcel: P47502  
Permit: BP15-0328  
Preparer: Edison Engineering  
Date: December, 2015

This drawing was created with a compass and tape measure and is approximate.  
**NOT A SURVEY**

500.17' *Check Critical Areas & Wetlands*  
*Jalen Cooper 12-28-15*