

When recorded return to:

Ray R. deVries  
Rebecca M. deVries  
16942 Calhoun Road  
Mount Vernon, WA 98273



201803300196

Filed for Record at Request of  
Land Title and Escrow  
Escrow Number: 154489-OE

Skagit County Auditor \$76.00  
3/30/2018 Page 1 of 3 3:30PM

Grantor: deVries Investments  
Grantee: deVries, Ray R. and Rebecca M.

m-21627  
Land Title

**QUIT CLAIM DEED**

THE GRANTOR DEVRIES INVESTMENTS, A WASHINGTON PARTNERSHIP for and in consideration of WAC#458-61A-211(1)(d) MERE CHANGE- CORPORATION/PARTNERSHIP conveys and quit claims to RAY R. DEVRIES AND REBECCA M. DEVRIES, HUSBAND AND WIFE the following described real estate, situated in the County of Skagit State of Washington, together with all after acquired title of the Grantor therein:

SEE ATTACHED EXHIBIT "A" HERETO FOR LEGAL DESCRIPTION

Abbreviated Legal: A: Lot 2, SP #00-0062, in 26-34-3 E W.M.; B: Tract B, Revised SP #46-81 in 26-34-3 E W.M.

Tax Parcel Number(s):

340326-2-006-0007, P22785

Dated: March 29, 2018

DEVRIES INVESTMENTS, A WASHINGTON PARTNERSHIP

By: Ray R. deVries, Managing Partner

20181272  
SKAGIT COUNTY WASHINGTON  
REAL ESTATE EXCISE TAX

MAR 30 2018

Amount Paid \$ 0  
Skagit Co. Treasurer  
By [Signature] Deputy

ACCOMMODATION  
RECORDING ONLY

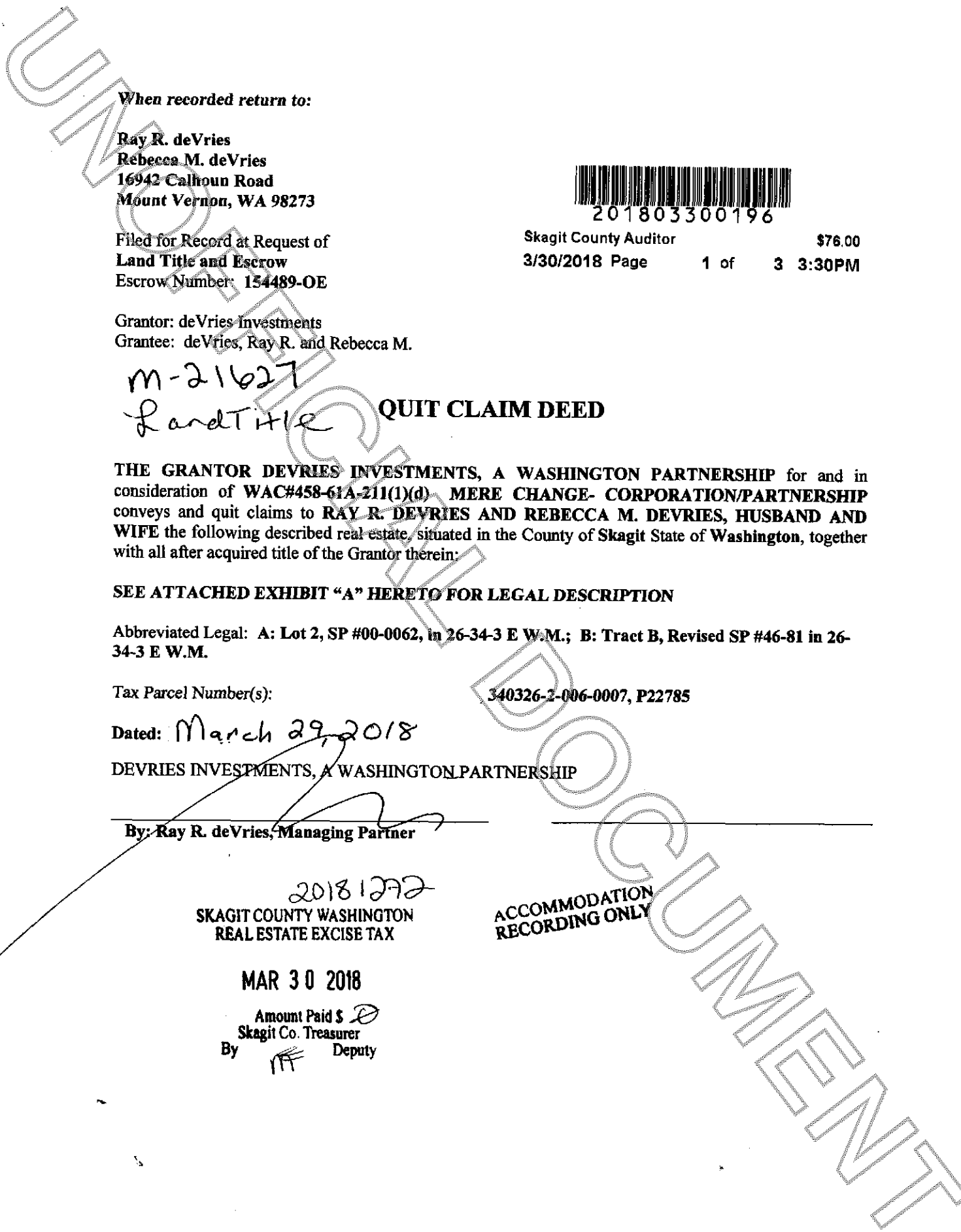

STATE OF Washington }  
COUNTY OF Skagit } SS:

I certify that I know or have satisfactory evidence that Ray R. DeVries signed this instrument, on oath stated that he / she / they are authorized to execute the instrument and acknowledged it as the Managing Partner of DeVries Investments, a Washington Partnership to be the free and voluntary act of such party for the uses and purposes mentioned in this instrument.

Dated: March 29, 2018

Karen Ashley  
Karen Ashley  
Notary Public in and for the State of Washington  
Residing at Sedro-Woolley  
My appointment expires: 9/11/2018

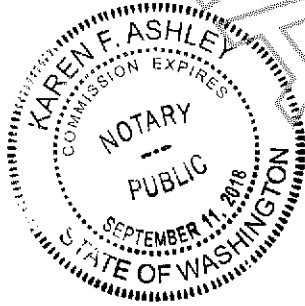

ALTA Owner's Policy (6/06)

Order No.: 154489-OE-A

Policy No.: OX10373443

**SCHEDULE "A-1"**

**DESCRIPTION**

That portion of Lot 2, Short Plat No. 00-0062, approved November 6, 2000, recorded November 8, 2000, under Auditor's File No. 200011080112, described as follows:

Beginning at the Southeast corner of said Lot 2, said point being on the East line of the Northwest  $\frac{1}{4}$ , North  $0^{\circ}25'41''$  East, 659.65 feet from the Southeast corner thereof;  
thence continuing on said East line North  $0^{\circ}25'41''$  East, 35.26 feet;  
thence North  $89^{\circ}22'54''$  West, 505.46 feet;  
thence South  $0^{\circ}25'41''$  West, 674.91 feet to the South line of said Lot 2;  
then South  $89^{\circ}22'54''$  East on said South line, 175.88 feet to the Easterly line of said Lot 2;  
thence North  $0^{\circ}37'06''$  East along said Easterly line 298.37 feet;  
thence South  $89^{\circ}22'54''$  East continuing along said Easterly line, 91.00 feet;  
thence North  $0^{\circ}37'06''$  East continuing along said Easterly line, 116.55 feet;  
thence North  $89^{\circ}22'54''$  West continuing along said Easterly line, 183.75 feet;  
thence North  $0^{\circ}37'06''$  East continuing along said Easterly line, 179.66 feet;  
thence South  $89^{\circ}22'54''$  East continuing along said Easterly line, 204.60 feet;  
thence North  $0^{\circ}37'06''$  East continuing along said Easterly line, 45.07 feet;  
thence South  $89^{\circ}22'54''$  East continuing along said Easterly line, 215.61 feet to the point of beginning.

Situate in the County of Skagit, State of Washington.