

LEGEND

- Property Corner
- Set 5/8" Diam. X 18" Length Steel Rebar
- w/Yellow Plastic Cap Imprinted: "LEGR0 37532"
- Set Concrete Nail and Flourissant Orange Flag
- w/Grass Washer Imprinted: "LEGR0 37532"
- Found Rebar w/Yellow Plastic Cap by "JUDY 7598"
- Edge of As-Built Oil Road
- Sewer Manhole
- Centerline of Road
- Centerline of Pipeline
- Found/Set Chalked Iron Nail
- Found/Set Rebar to the Date of this Survey
- Unless Otherwise Noted.



SURVEYOR'S CERTIFICATE

This map correctly represents a survey made by the order of my client, RILEY JUNGQUIST PROPERTY SURVEY, on the 1st day of January, 2021, at 10:00 AM, at the request of RILEY JUNGQUIST, Recording #41, December 24, 2020 of the county of Skagit, Washington.

LEGR0 & ASSOCIATES, LLC
 Professional Land Surveyors
 13271 South 2nd Street
 Mount Vernon, WA 98273
 Phone: (360) 396-3220

DENNIS D. RILEY
 Registered Professional Land Surveyor
 Lic. # 13271 Date: 02-04-21

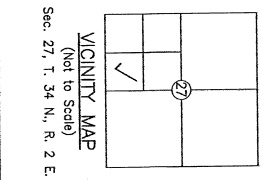
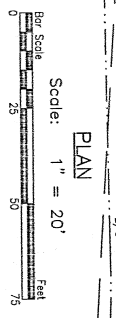

RECORD OF SURVEY

RILEY JUNGQUIST PROPERTY SURVEY

LOT 22, PLAT OF
 "SNEE-OOSH, SKAGIT COUNTY, WASH."
 PIN, GOVT LOT 4, SEC. 27, T. 34 N., R. 2 E.W.M.
 SKAGIT COUNTY, WASHINGTON

AUDITOR'S CERTIFICATE

Filed for the record this 7th day of January, 2021, at 10:00 AM, at the office of the Auditor of Skagit County, Washington.

Records of Skagit County, Washington

Shirley A. Rieker
 Skagit County Auditor
 Deputy

LEGAL DESCRIPTION

Parcel "P-1" (P89828)
 Lot 22, "SNEE-OOSH, SKAGIT COUNTY, WASHINGTON," as per plat recorded in Volume 4 of Plats, page 50, records of Skagit County, Washington.

Situate in the County of Skagit, State of Washington.

- NOTES**
1. Legal description for this survey is based upon Quit Claim Deed from Charles O. Leming and Joan M. Leming, Grantors to J & B Family Limited Partnership by that instrument recorded under Auditor's File No. 9712160017, records of Skagit County, Washington, refer to Surveys recorded under Auditor's File No. B108240050.
 2. For additional subdivision information, refer to Surveys recorded under Auditor's File No. B108240050, County of Washington, 2017/082-10156, records of Skagit County, Washington.
 3. Basis of bearings: the Centerline of Chilberg Avenue as being N 88°27'16" W based upon existing monumentation.
 4. Survey Method: Field Traverse
 5. Instrumentation: TOPCON PS-103
 Theodolite: Min. Resolution/Accuracy 3"
 EDM: Accuracy ± (1.55mm + 2ppm)
 6. Meridian - Assumed
 7. Distances shown are in feet and decimals of a foot.
 8. This survey has been completed without the benefit of a current title report and may be subject to easements, covenants, restrictions, reservations or other instruments of record.
 9. This survey depicts occupational indicators that may be the basis for claims of unwritten title ownership. This survey does not purport to resolve such claims, if any.