



202304050054

04/05/2023 03:33 PM Pages: 1 of 2 Fees: \$204.50
Skagit County Auditor

Return to:

PROTECTED CRITICAL AREA SITE PLAN

This PCA amends AF# 201708240040

Page 1 of 2

Grantor/Owner: Mark & Ericka Catubo

Grantee: PUBLIC

Site Address: 24300 Lee Road

Property ID #: P133770

Assessors Tax Account #: 4135-030-017-1008

Legal Description: SW ¼ NW ¼ Sec. 6 Twp. 33N Rng. 5E

Permit/Activity #: CE22-0084

The PROTECTED CRITICAL AREA (PCA) is to be left undisturbed in its natural state. "With the exception of activities identified as Allowed without Standard review under SCC 14.24.070, any land-use activity that can impair the functions and values of critical areas or their buffers through a development activity or by disturbance of the soil or water, and/or by removal of, or damage to, existing vegetation shall require critical areas review and written authorization pursuant to SCC 14.24." SCC 14.24.060

No clearing, grading, filling, logging or removal of woody material, building, construction or road construction of any kind, planting of non-native vegetation or grazing of livestock is allowed within the PCA areas except as specifically permitted by Skagit County on a case-by-case basis consistent with SCC 14.24.

Representations on this site plan may be approximations only and should not be used for purposes other than for determining general locations of critical areas. Development activities beyond the scope of this plan may require additional studies and approvals.

The above references to "Grantor" and "Grantee" shall not be construed as a transfer of property ownership and are used solely for filing with the County Auditor.

Owner: [Signature] Date: 3/29/23

On this day personally appeared before me Ericka Catubo, to me known to be the individual(s) described in and who executed the within and foregoing instrument, and acknowledged that he/she/they signed the same as his/her/their free and voluntary act and deed, for the uses and purposes therein mentioned.

Given under my hand and seal of office this 29 day of March, 20 23

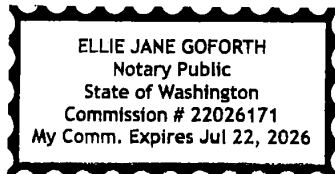

[Signature]
Notary Public residing at Burlington
My Commission Expires: 7/22/26

CATUBO SITE CRITICAL AREAS MAP

P133770
24300 LEE ROAD

CAO Approved *Leah Finn*
3/27/2023

This PCA amends AF#201708240040 to remove the wetland buffer. Pursuant to SCC 14.24.230(6)(a) this wetland is exempt from County regulation.

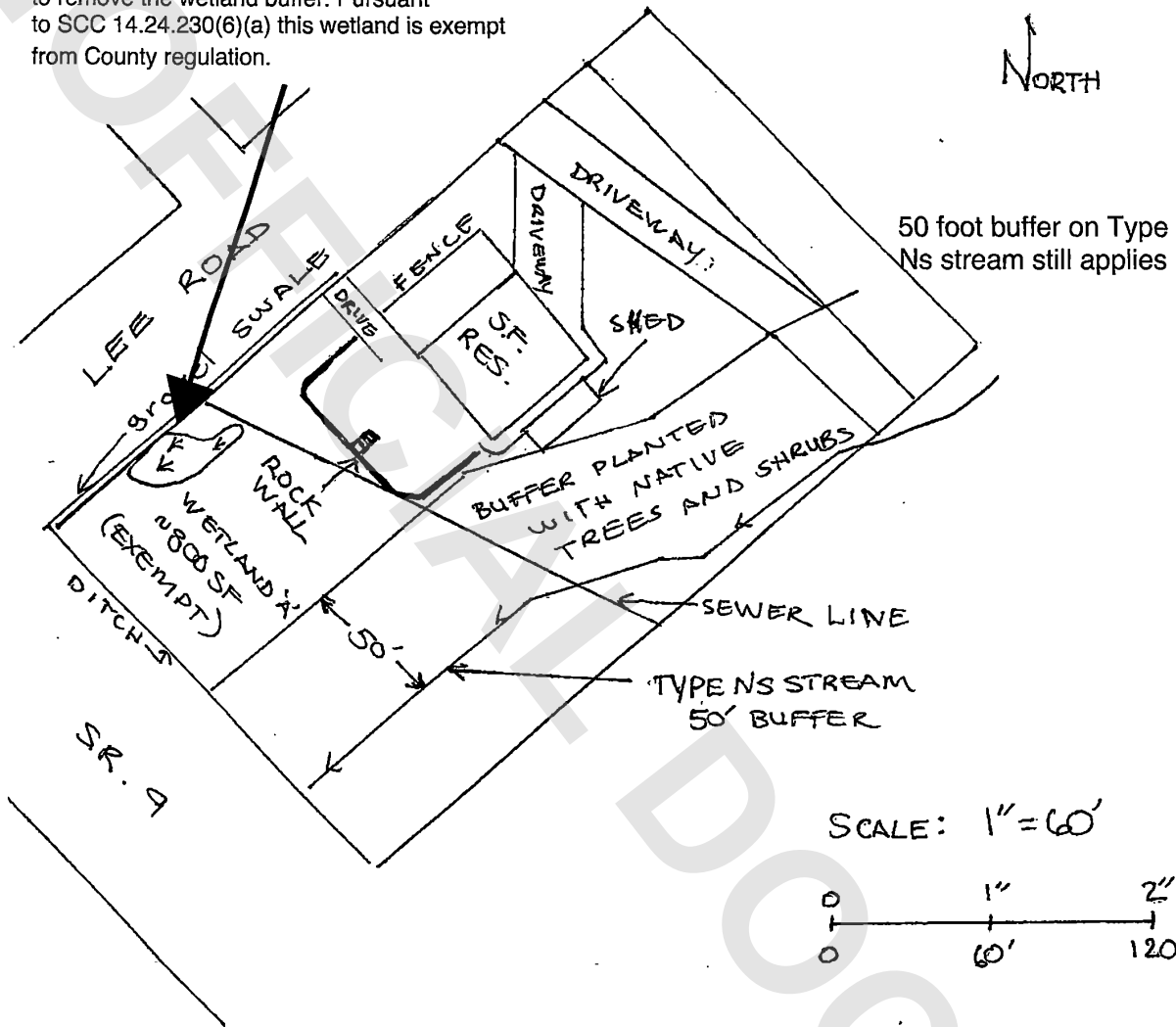

GRIBBLE ENVIRONMENTAL
CONSULTING COMPANY
Karl Gribble
360-422-5144