

FOUND CORNER INFORMATION

- 1/2" REBAR/CAP CASCADE AT CALC CORNER 1 1/2" CORNER IRON PIPE 0.4' NORTH 1 0.5' WEST OF CALC CORNER
- 1" CORNER IRON PIPE 0.7' SOUTH 1 0.5' WEST OF CALC CORNER
- 1" CORNER IRON PIPE 0.1' SOUTH 1 0.6' WEST OF CALC FIELD AS CORNER
- 1" CORNER IRON PIPE 1.0' NORTH 1 0.5' EAST OF CALC
- 1" CORNER IRON PIPE LOOSE IN GROUND 0.1' NORTH 1 1.0' WEST OF CALC SET 1/2" REBAR/CAP TIESER 20/23/64" AT CALC CORNER
- 1" IRON PIPE LOOSE IN GROUND 0.1' NORTH 1 0.2' EAST OF CALC AND NORTH 1 0.1' WEST OF CALC 0.4' NORTH 1 0.1' WEST OF CALC
- 1/2" REBAR/CAP TIESER 20/23/64" AT CALC CORNER
- 1/2" REBAR/CAP CASCADE 0.1' NORTH 1 0.2' EAST OF CALC AND NORTH 1 0.1' WEST OF CALC
- 1/2" REBAR/CAP TIESER 1.5' NORTH 1 0.2' NORTH 1 0.1' WEST OF CALC
- 1/2" REBAR/CAP CASCADE 0.2' WEST OF CALC

LINE TABLE

LINE	BEARING	DISTANCE
LI	N64°20'00"E	30.00'

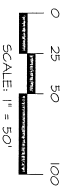

SURVEYOR'S CERTIFICATE

THIS MAP CORRECTLY REPRESENTS A SURVEY MADE BY ME OR UNDER MY DIRECTION IN CONFORMANCE WITH THE REQUIREMENTS OF THE SURVEY RECORDING ACT AT THE REQUEST OF ROBERT MANNERY AND KRISTEL MANNERY, A MARKED COUPLE, IN JULY 2024.

KEVIN G. LISSEB, P.L.L.C., CERTIFICATE NO. 20123164 DATE 7-15-24
 3302 MILWAUKEE ST. SUITE 103
 MOUNT VERNON, WA 98273
 PHONE (360) 414-7442
 FAX (360) 414-0581
 E-MAIL KEVIN@LISSEB.COM

AUDITOR'S CERTIFICATE

FILED FOR RECORD AT THE REQUEST OF LISSEB & ASSOCIATES, PLLC. FILED FOR RECORD THIS 15 DAY OF JULY, 2024 AT 01 MINUTES PAST 10 O'CLOCK P.M. IN VOLUME 202407150066 PAGES 1 UNDER AUDITOR'S FILE NO. 202407150066 RECORDS OF SKAGIT COUNTY, WASHINGTON.

Stephanie A. Bink
 SKAGIT COUNTY AUDITOR
 DEPUTY
Justin A. Wada

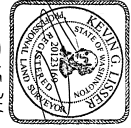

SURVEY DESCRIPTION

LOT 34, BLOCK 2, LAKE CAYAWACH SUBDIVISION, DIVISION NO. 1, 1" AS PER PLAT RECORDED IN VOLUME 5 OF PLATS, PAGES 37 THROUGH 43, INCLUSIVE, RECORDS OF SKAGIT COUNTY, WASHINGTON. SUBJECT TO AND TOGETHER WITH EASEMENTS, RESERVATIONS, RESTRICTIONS, COVENANTS, LIENS, LEASES, CONVEYANCES AND OTHER INSTRUMENTS OF RECORD.

NOTES

- INDICATES REBAR SET AND CAPPED WITH YELLOW CAP DESCRIBED LISSEB 20123164.
- INDICATES EXISTING PIPE OR REBAR FOUND AS NOTED
- INDICATES EXISTING MONUMENT AS NOTED
- DESCRIPTION FOR THIS SURVEY IS BASED UPON STATUTORY WARRANTY DEED RECORDED UNDER SKAGIT COUNTY AUDITOR'S FILE NUMBER 202010160122.
- FOR ADDITIONAL SURVEY AND SUBDIVISION INFORMATION SEE 'LAKE CAYAWACH SUBDIVISION' PLAT RECORDED UNDER SKAGIT COUNTY AUDITOR'S FILE NUMBERS 981240022, 9409210023, 891070005, AND 20190330022, ALL IN RECORDS OF SKAGIT COUNTY AUDITOR.
- INSTRUMENTATION: TRIMBLE 5-5 TOTAL STATION
- SURVEY PROCEDURE: STANDBY FIELD TRANSVERSE
- MERIDIAN: ASSUMED
- BASIS OF BEARINGS: MONUMENTED CENTRALINE OF NORTH SHORE DRIVE
- BEARINGS = SOUTH 25°40'00" EAST

- THIS SURVEY WAS PERFORMED AT THE REQUEST OF ROBERT MANNERY AND KRISTEL MANNERY, A MARKED COUPLE, FOR THE DELINEATION AND STAKING OF THE DESCRIBED PROPERTY, AS SHOWN.
- EXCEPT AS SPECIFICALLY STATED OR SHOWN ON THIS SURVEY MAP, THIS SURVEY DOES NOT PURPORT TO REFLECT ALL OF THE FOLLOWING, WHICH MAY BE APPLICABLE TO THE SUBJECT REAL ESTATE: EASEMENTS, BUILDING SETBACK LINES, RESTRICTIVE COVENANTS, SUBDIVISION RESTRICTIONS, ZONING OR OTHER LAND-USE REGULATIONS, NO TITLE REPORT WAS PROVIDED.
- ALL DISTANCES SHOWN HEREON ARE IN U.S. SURVEY FEET.

- THIS SURVEY FOUND OCCUPATIONAL INDICATORS (TRAIL, RAILROAD TIE BORDER) AS PER MAC CHAPTER 332-130. LINES OF OCCUPATION MAY BOUNDARY SURVEY HAS NO CLAIM OF UNWRITTEN OWNERSHIP. THIS OCCUPATION TO THE DEEDED LINES OF RECORD. NO RESOLUTION OF OWNERSHIP BASED ON UNWRITTEN RIGHTS HAS BEEN MADE OR IMPLIED BY THIS SURVEY.

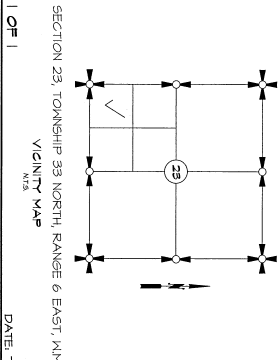

SHEET 1 OF 1
 DATE: 7/19/24
 SURVEY IN A PORTION OF THE
 SW 1/4 OF THE SW 1/4 OF
 SECTION 23, T. 33 N., R. 6 E., 11M,
 SKAGIT COUNTY, WASHINGTON
 FOR: ROBERT & KRISTEL MANNERY
 LISSEB & ASSOCIATES, PLLC (SCALE: 1" = 50')
 HERIDIAN: ASSUMED
 SKAGIT COUNTY AUDITOR
 KEVIN G. LISSEB
 MOUNT VERNON, WA 98273
 PHONE (360) 414-7442
 FAX (360) 414-0581
 E-MAIL KEVIN@LISSEB.COM