

LEGEND

- ☒ TYPE 1 JUNCTION BOX
- ⊠ FLASHER CABINET AND FOUNDATION
- ← FLASHER
- △ WIRE NOTE
- ⬡ CONSTRUCTION NOTE
- ⬢ SIGN
- CONDUIT RUN
- - - ROW
- 6' DIAMETER LOOP

GENERAL NOTES

1. ALL WORK SHALL BE DONE IN ACCORDANCE WITH THE CURRENT WSDOT/APWA STANDARD SPECIFICATIONS, SKAGIT COUNTY SPECIAL PROVISIONS, WSDOT STANDARD PLANS, AND THESE PLANS.
2. FLASHING BEACON SHALL HAVE 12 INCH LENSE WITH LED LIGHT SOURCES.
3. CONDUIT SHALL BE SCH 40 UNLESS UNDER PAVEMENT WHERE IT SHALL BE SCH 80. ALL CONDUIT SHALL HAVE 24 INCHES OF COVER.
4. ALL VEHICLE DETECTION LOOPS SHALL BE WHERE SHOWN ON THE PLANS. SEE WSDOT STANDARD PLAN J-50.12-00.
5. ALL JUNCTION BOX LOCATIONS AND CONDUIT RUNS ARE APPROXIMATE AND SHALL BE APPROVED BY ENGINEER BEFORE INSTALLATION.
6. STOP BAR MATERIAL SHALL BE THERMOPLASTIC.
7. FLASHER CABINET SHALL BE WESTERN SYSTEMS FC 160; MODEL #3000150005. BRACKETS ARE MODEL 3610015000.

LOOP SCHEDULE					
LOOP#	TYPE	STATION OFFSET	LOOP#	TYPE	STATION OFFSET
1	3S	9+50.00, 0' RT	2	3S	100+00.00, 0.6' RT
			3	3A	105+95.00, 5' LT

NOTE:
STATION AND OFFSET REFERENCED TO THE LEADING LOOP CENTER POINT FOR ALL TYPE 3S LOOPS.

WIRING SCHEDULE					
△ RUN NO.	CONDUIT RACEWAY	LOOP CABLE 2cs	FLASHER POWER #10	SERVICE #4	COMMENT
1	1.5"			3	120/240 VAC BY PSE
2	2"	2	5		SCH 80
3	1"		3		SCH 80
4	1"	1	3		
5	2"	3	7		
6	1"	1			
7	1.5"	1			GALVANIZED

CONSTRUCTION NOTES

1. CONNECT SERVICE TO TRANSFORMER AT STA. 5+25.97, 19.28' RT. COORDINATE POWER CONNECTION WITH PSE.
2. CONSTRUCT FOUNDATION, FURNISH AND INSTALL TYPE PS POLE AND FLASHER CABINET AT STA. 9+24.00, 21' RT. SEE SHEET 2 DETAIL A.
3. CONSTRUCT FOUNDATION, FURNISH AND INSTALL "ALTERNATING FLASHING BEACON TYPE 1" AT STA. 99+90.00, 18' LT. SEE WSDOT STANDARD PLAN J-21.16-01 AND J-21.10-04. SEE SHEET 2 DETAIL B.
4. CONSTRUCT FOUNDATION, FURNISH AND INSTALL "ALTERNATING FLASHING BEACON TYPE 1" AT STA. 102+57.00, 15'LT AND STA 97+50, 20' RT. SEE SHEET 2 DETAIL C AND E.
5. REMOVE EXISTING STOP BAR AND INSTALL NEW 12" STOP BAR AT STA. 9+66.74.
6. ALL CONDUIT OVER BRIDGE BETWEEN JUNCTION BOXES SHALL BE 1.5" GALVANIZED, INCLUDING ALL 90 DEGREE BENDS (R=6" MIN). CONDUIT SHALL BE ATTACHED TO BACKSIDE OF GUARDRAIL POSTS USING GALVANIZED 2-HOLE CLAMPS AND SHALL BE ATTACHED TO EACH POST, AND TWO CLAMPS AT EACH RISER 16" OC. SEE SHEET 2 DETAIL D.

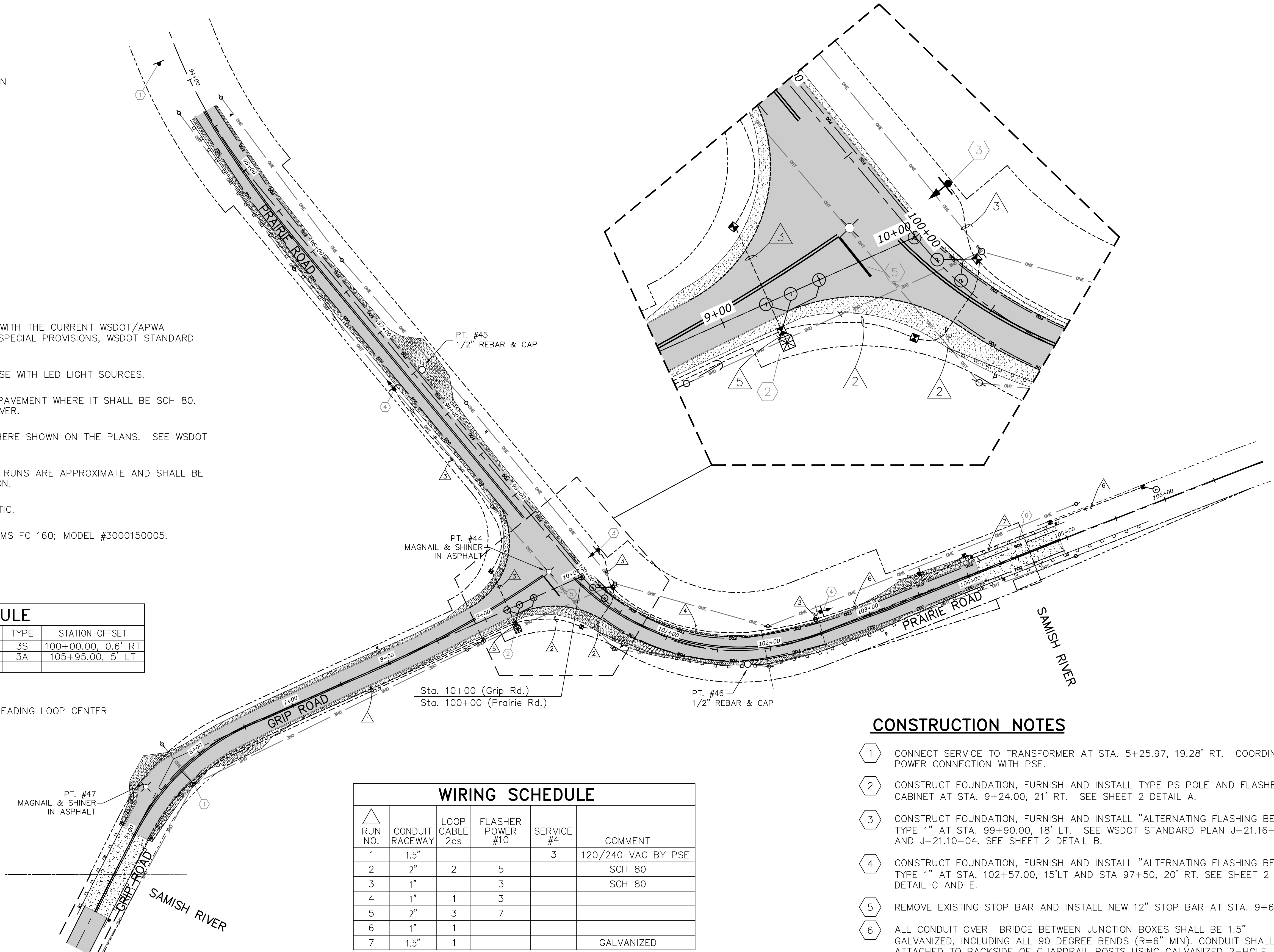

DN TRAFFIC CONSULTANTS
P.O. box 547 Preston, WA 98050
425.765.5721

COPYRIGHT 2020
SEMRAU ENGINEERING & SURVEYING, PLLC
CIVIL ENGINEERING • LAND SURVEYING • PLANNING
2118 RIVERSIDE DRIVE - SUITE 208
MOUNT VERNON, WA 98273
360-424-9566

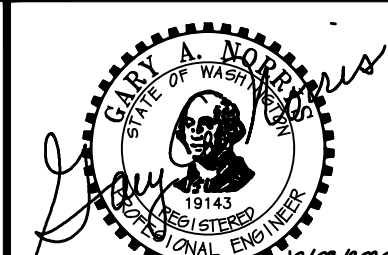

NO.	DATE	REVISION	BY	REV.

**PRAIRIE RD & GRIP RD
INTERSECTION TRAFFIC
IMPROVEMENTS**

SCALES:
HORIZONTAL: 1" = 50'
VERTICAL: N/A
NOTE: IF THIS SHEET IS LESS THAN 22"x 34" THEN SHEET HAS BEEN REDUCED

CONCRETE NOR'WEST
GRIP ROAD GRAVEL MINE
SECTION 4, T. 35 N., R. 4 E., W.M.
SKAGIT COUNTY, WASHINGTON

FIELD BK/PG:
DATE: 8/27/20
DRAWING: 5166FBD.DWG
JOB NO.: 5166
SHEET: 1